

# Product Catalog | ver. 8



*"The healthy coexistence of people and animals through the control of disease"*

All living things are exposed to diseases during their life, and mankind has developed diagnostic tests and medicines for treatment of many of these diseases. There still remain diseases that we have not managed to overcome, and new diseases continue to emerge.

Diagnostics is the first step needed to manage these diseases. Early and accurate detection is very important for administering suitable treatment, as well as the prevention and control of the diseases spreading through a population.

BIONOTE products play a central role in the business of disease diagnostics. With its expertise in detection techniques, continual research and development and proven ability to produce new and innovative diagnostic products, BIONOTE will continue to grow.

The BIONOTE dream is to assist in achieving a healthy life for people, animals and all living things, by trying to create a society which has "The healthy coexistence of people and animals through the control of disease".

BIONOTE has distribution channels in over 80 countries globally

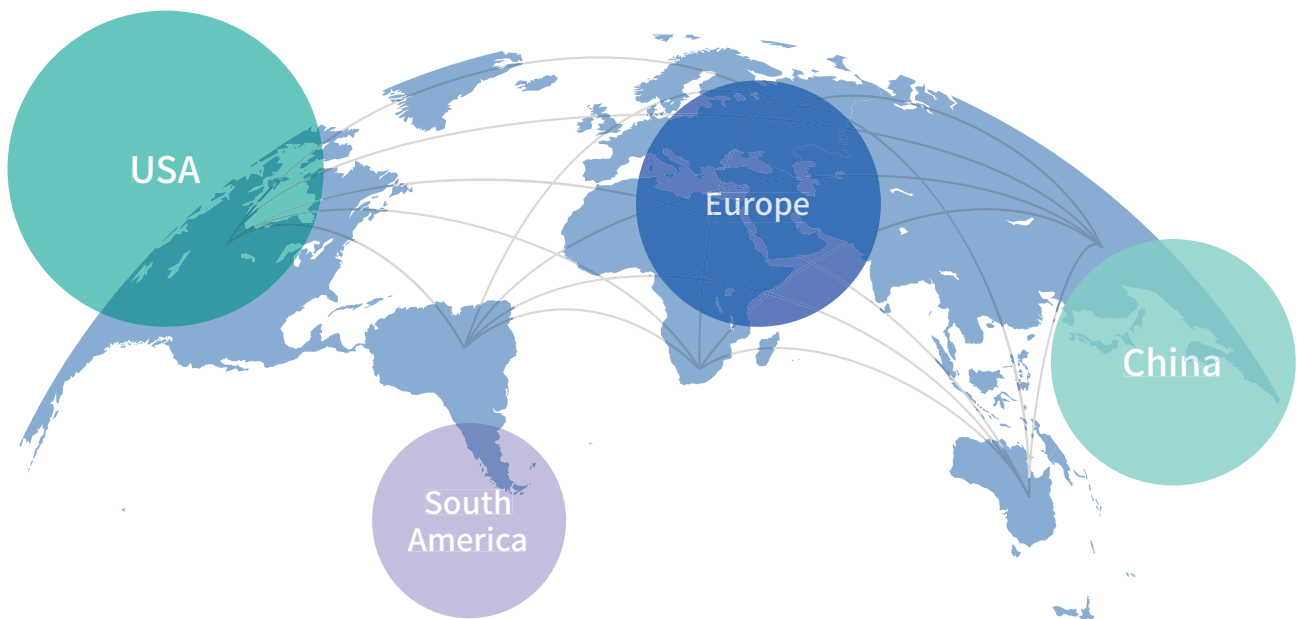

## INTRODUCTION

BIONOTE, Inc. was established in the beginning of 2003, and is considered a pioneer of in-vitro Diagnostics for veterinary needs. BIONOTE delivers innovative and creative solutions for our customers improving their vet healthcare. BIONOTE has its own automated facility to manufacture a wide range of high quality products developed by a highly competent R&D center. BIONOTE has manufactured diagnostic products in accordance with ISO 9001:ISO13485 certification, and has expanded overseas sales network in over 80 countries and is still continuing to grow.

# HISTORY

2003  
~2008

- 2003. 03 Anigen, Inc. established
- 2003. 11 Acquired animal medicine import license
- 2003. 12 Acquired animal medicine manufacturing industry permission
- 2004. 09 Acquired ISO 9001:2000 TUV certification
- 2006. 04 Canine Distemper virus antibody diagnostic kit patent acquisition
- 2006. 04 Canine Parvovirus antibody diagnostic kit patent acquisition
- 2006. 06 Venture business certification (No.061627021-01133)
- 2006. 07 Technical innovation medium and small enterprises certification (No.6065-1216)
- 2007. 09 H5 and general pathogenic avian influenza virus antigen diagnostic
- 2007. 11 Name change of Anigen, Inc. to Animal Genetics, Inc.
- 2007. 12 Winner of the Animal medicine manufacturer self-regulation checking system Prize
- 2008. 02 World's first influenza H3N2 type confirmation assay development
- 2008. 07 Novel canine influenza viruses and vaccine patent acquisition
- 2008. 12 Winner of the Animal medicine manufacturer self-regulation checking system Prize

2009  
~2015

- 2009. 01 Anigen AIV Ab ELISA knowledge economics department new product certification (NEP) acquisition
- 2009. 02 Name change of Animal genetics, Inc. to BIONOTE, Inc.
- 2009. 05 Food & Drug Administration medicine manufacturing industry permission acquisition
- 2009. 12 ISO 2003:13485 TUV certification acquisition Anigen Rapid Canine Heartworm Ag Test Kit USDA licensed
- 2011. 01 Acquisition by Alere
- 2012. 02 Built the 2nd building for Manufacturing, Warehouse, R&D lab.
- 2012. 04 Registered International Patent (PCT) for "A Novel Canine influenza virus and Vaccine"
- 2013. 02 AniGen TB-feron ELISA kit was assigned as an official diagnosis method for bovine tuberculosis eradication program in Korea
- 2014. 11 Spun off as an independent company from Alere, Inc. (USA)
- 2014. 12 Expanded Manufacturing facility
- 2015. 11 Expanded office and laboratory by moving to a new building

2016  
~

- 2016. 09 Launched Vcheck F, a fluorescence device for animals
- 2018. 04 Research facility BL3 (Biosafety Laboratory) Room certified for the first time by the government
- 2020.06 Developed NowCheck COVID-19 Ag/Ab Test (CE certification)
- 2020.06 Development of NowCheck COVID-19 Ag/Ab Test (CE certified)
- 2022.09 Launched Vcheck M, State-of-the-art POC molecular system
- 2022.12 Vcheck F global cumulative sales passes 16,000 units (World's best selling fluorescence immunoassay analyzer)

# CONTENTS

<b>Antibody Titer</b>	CPV Ab 3.0, CDV Ab 3.0	_06
<b>Canine Diarrhea</b>	CCV Ag	_08
	CPV Ag	_09
	Giardia Ag	_10
	CPV/CCV Ag	_11
	CPV/CCV/Giardia Ag	_12
	CPV/CCV/Giardia Ag 2.0	_13
<b>Canine Respiratory</b>	CDV Ag	_14
	CIV Ag	_15
	CDV/CAV Ag	_16
	CIRD-3 Ag	_17
<b>Canine Vector-borne / Others</b>	C.Brucella Ab	_18
	Canine Babesia Ab	_19
	CHW Ag 2.0	_20
	E.canis Ab	_21
	Leishmania Ab	_22
	Rabies Ag	_23
	Total IgE	_24
	E.canis/Anaplasma Ab	_25
	CaniV-4	_26
	CaniV-4 (Leish)	_27
<b>Feline Diarrhea</b>	FCoV Ab	_28
	FCoV Ag	_29
	FPV Ag	_30
	FCoV Ag/Ab	_31
	FeliD-3	_32
<b>Feline Respiratory / Others</b>	FCV Ag	_33
	FHV Ag	_34
	Toxoplasma Ab	_35
	FHW Ag/Ab	_36
	FIV Ab	_37
	FeLV Ag	_38
	FIV Ab/FeLV Ag	_37
	FIV Ab/FeLV Ag 2.0	_38
FeliCheck-3	_39	

# CPV Ab 3.0, CDV Ab 3.0

## General Information

**Purpose :** Titration of canine IgG antibody against Canine Parvovirus (CPV) or Canine Distemper virus (CDV)

**Principle :** Immunochromatographic assay

**Specimen :** Canine whole blood, plasma or serum

**Materials provided :**

- Anigen Rapid CPV Ab/CDV Ab test device
- Assay diluent tube
- Disposable inverted cup (5 µl)
- Specimen sheet
- Anticoagulant tube
- Disposable dropper
- Color scale (1~6) measurement

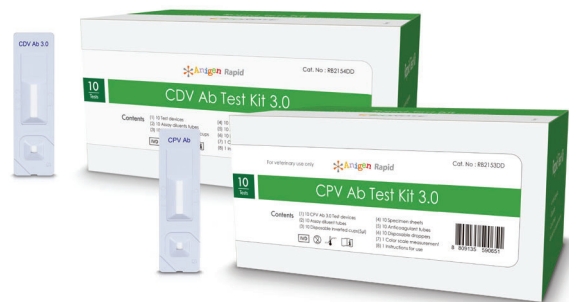

**Special Features :**

- World's first CPV Ab and CDV Ab titer rapid immunochromatographic test kit
- Semi - quantitative detection of IgG antibodies
- One step testing procedure : Easy to use, Saving time and labor
- Quick & Accurate
- High sensitivity and specificity compared with HI (CPV) & VN (CDV) test
  - Sensitivity : CPV 95.4% / CDV 96.9%
  - Specificity : CPV 97.0% / CDV 100%

## Test Procedure

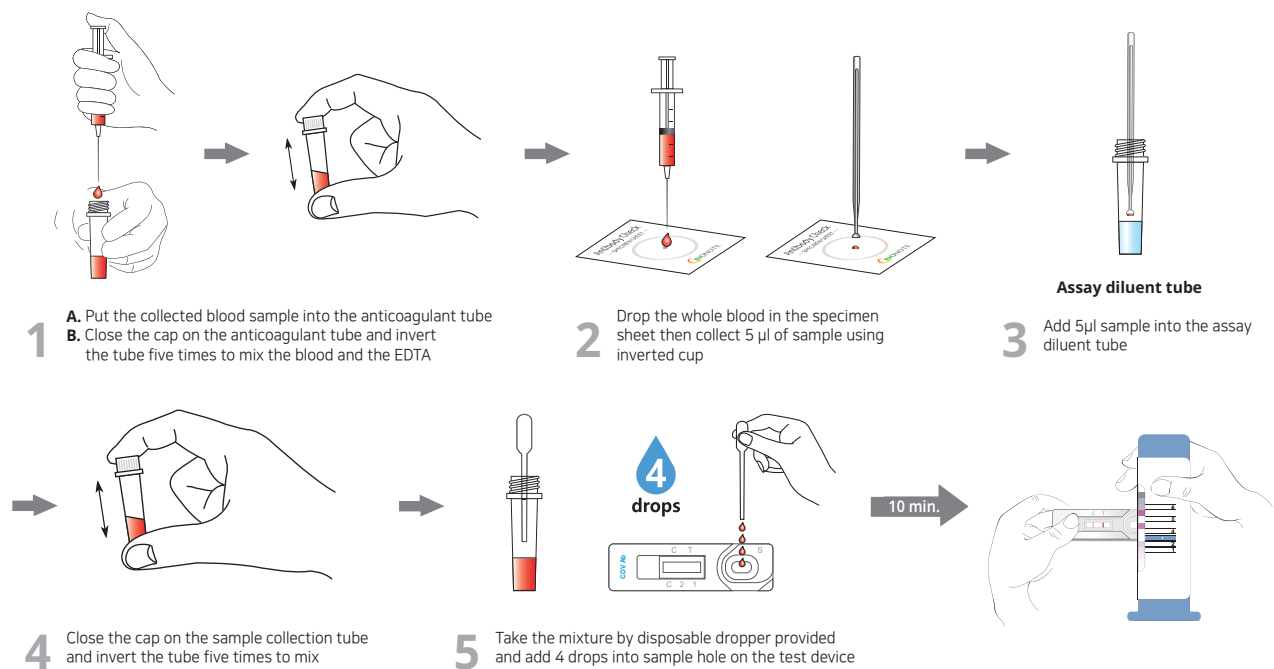

## Ordering Information

Cat. No.	Description	Type	pack size
RB2153DD	CPV Ab 3.0	Device	10 Tests/Kit
RB2154DD	CDV Ab 3.0	Device	10 Tests/Kit

## Application

- For serological diagnosis of CPV and CDV infection
- For the prediction of prognosis in patients with CPV or CDV
- For assessment of immune status of puppies after vaccination
- For determination of the proper time of vaccination by measuring a maternal antibody titer
- For determination of the proper time for revaccination

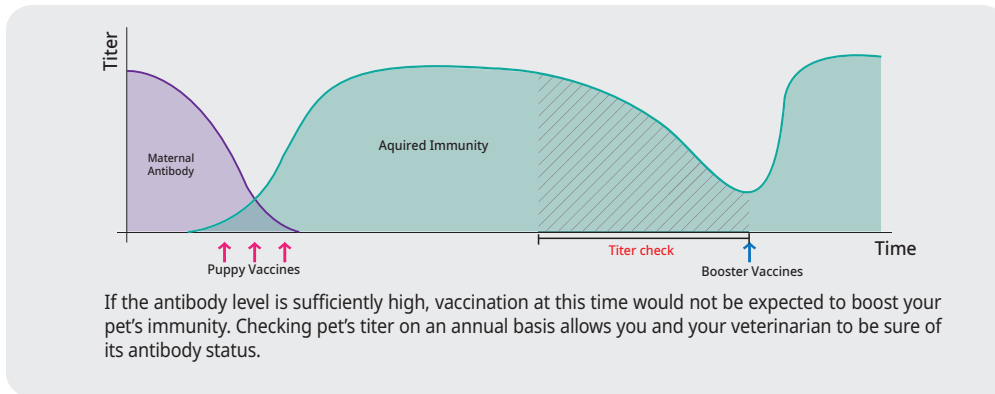

## Reading the result of titer check system

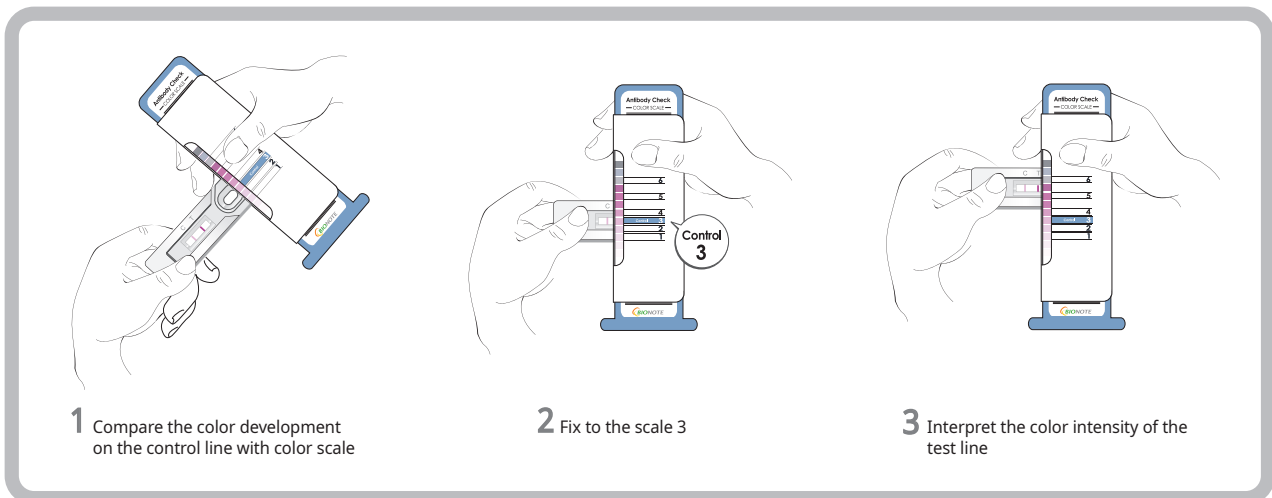

Line color Intensity	Titer	Color scale level and immune status
<div style="display: flex; justify-content: space-around;"> <span>C</span> <span>T</span> </div>	CPV - HI below 1:40 CDV - VN below 1:4	The color development of T line is weaker than that of C line (Color scale 1-2) **Antibody titer is low against CDV or CPV This is indicative of poor immune status (additional vaccination required)
<div style="display: flex; justify-content: space-around;"> <span>C</span> <span>T</span> </div>	CPV - HI 1:80 CDV - VN 1:8	The T line has equal color development with C lines (Color scale 3) **Antibody titer is medium against CDV or CPV This is indicative of a good immune status
<div style="display: flex; justify-content: space-around;"> <span>C</span> <span>T</span> </div>	CPV - HI Above 1:160 CDV - VN Above 1:16	The color development of T line is higher or same with C line (Color scale 4-6) **Antibody titer is high against CDV or CPV This is indicative of an excellent immune status

# Anigen Rapid CCV Ag

## General Information

**Purpose :** Detection of Canine Coronavirus (CCV) antigen

**Principle :** Immunochromatographic assay

**Specimen :** Canine fecal swab

**Materials provided :**

- Anigen Rapid CCV Ag test device
- Assay diluents tube
- Disposable swab
- Disposable dropper

**Special Features :**

- World's first CCV Ag rapid test
- One-step testing procedure : Quick & Accurate
- High sensitivity and specificity compared with Nested PCR
  - Sensitivity : 93.1%
  - Specificity : 97.5%



## Test Procedure

[ Proper sample amount collected by a swab ]

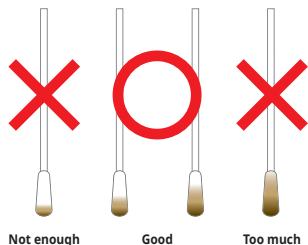

**1** Collect a sample from the canine feces by using the swab

**2** Insert the swab into the sample collection tube and stir the swab at least 10 times

**3** Discard the swab while squeezing the swab against the wall of the tube

**4** Wait until large particles to sink and take the supernatant by using the disposable dropper provided

**5** Add 4 drops into the sample hole on the test device

5~10 min.

### Interpretation

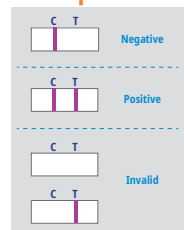

## Ordering Information

Cat. No.	Description	Type	Pack size
RG1104DD	CCV Ag	Device	10 Tests/Kit



# Anigen Rapid CPV Ag

## General Information

**Purpose :** Detection of Canine Parvovirus (CPV) antigen

**Principle :** Immunochromatographic assay

**Specimen :** Canine fecal swab

**Materials provided :**

- Anigen Rapid CPV Ag test device
- Assay diluents tube
- Disposable swab
- Disposable dropper

**Special Features :**

- Detection of pathogenic CPV subtypes (CPV 2, 2a, 2b & 2c)
- No interference of test results by the vaccination
- One-step testing procedure : Quick & Accurate
- High sensitivity and specificity compared with HA test
  - Sensitivity : 100%
  - Specificity : 100%



## Test Procedure

[ Proper sample amount collected by a swab ]

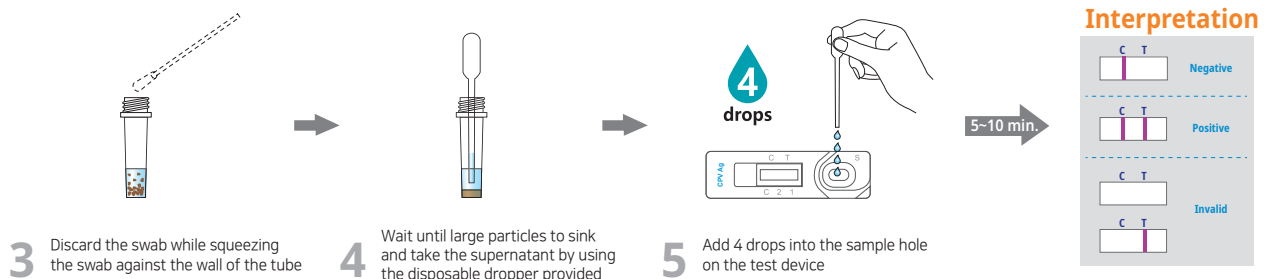
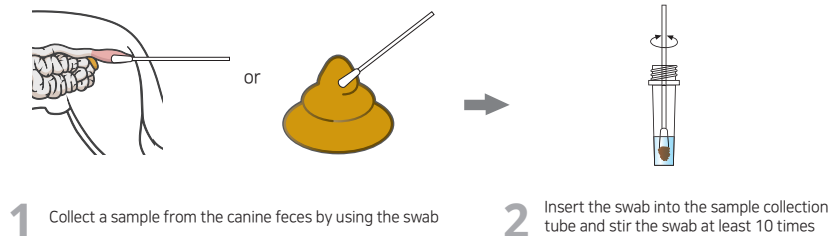
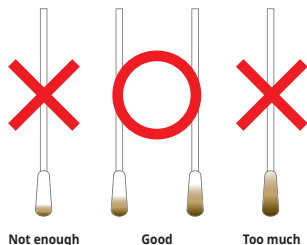

## Ordering Information

Cat. No.	Description	Type	Pack size
RG1101DD	CPV Ag	Device	10 Tests/Kit

# Giardia Ag

## General Information

**Purpose :** Detection of vegetative stages and cysts of Giardia

**Principle :** Immunochromatographic assay

**Specimen :** Canine, Feline fecal swab

**Materials provided :**

- Anigen Rapid Giardia Ag test device
- Assay diluents tube
- Disposable swab
- Disposable dropper

**Special Features :**

- Able to detect the pathogen in both dogs and cats
- One-step testing procedure : Quick & Accurate
- High sensitivity and specificity compared with Real-time PCR
  - Sensitivity : 100%
  - Specificity : 100%
- Detection limit: 125/100 µl



## Test Procedure

[ Proper sample amount collected by a swab ]

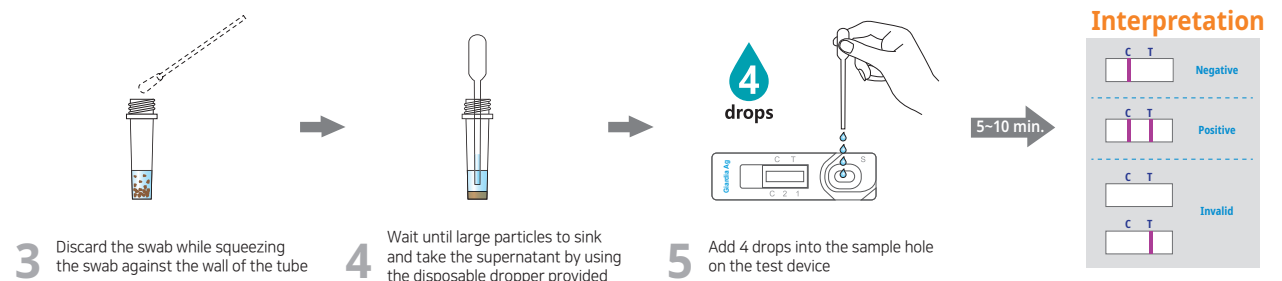
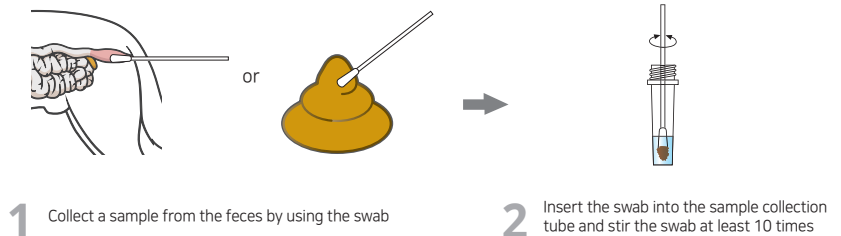
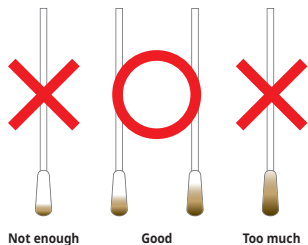

## Ordering Information

Cat. No.	Description	Type	Pack size
RG1804DD	Giardia Ag	Device	10 Tests/Kit

# Anigen Rapid CPV/CCV Ag

## General Information

**Purpose :** Detection of Canine Parvovirus (CPV) and Canine Coronavirus (CCV) antigen

**Principle :** Immunochromatographic assay

**Specimen :** Canine fecal swab

**Materials provided :**

- Anigen Rapid CPV/CCV Ag test device
- Assay diluents tube
- Disposable swab
- Disposable dropper

**Special Features :**

- Simultaneous detection of CPV and CCV with one specimen preparation
- One-step testing procedure : Quick & Accurate
- High sensitivity and specificity



## Test Procedure

[ Proper sample amount collected by a swab ]

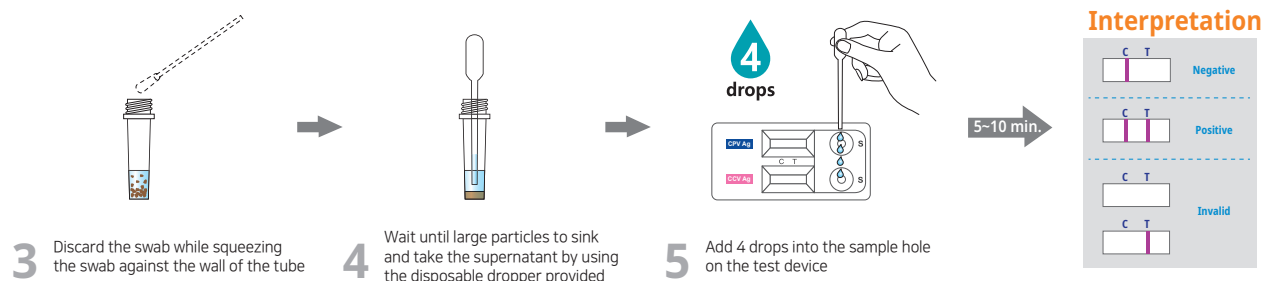
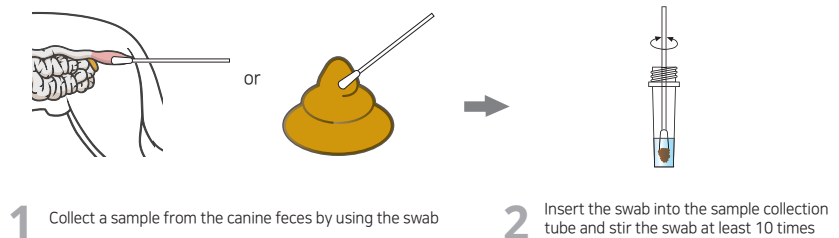
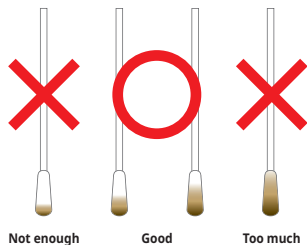

## Ordering Information

Cat. No.	Description	Type	Pack size
RC1105DD	CPV/CCV Ag	Dual Device	10 Tests/Kit

# CPV/CCV/Giardia Ag

## General Information

**Purpose :** Detection of Canine Parvovirus (CPV), Canine Coronavirus (CCV) and Giardia antigen

**Principle :** Immunochromatographic assay

**Specimen :** Canine fecal swab

**Materials provided :**

- Anigen Rapid CPV/CCV/Giardia Ag test device
- Assay diluents tube for CPV/CCV Ag (P)
- Assay diluents tube for Giardia Ag (G)
- Disposable swab
- Disposable dropper

**Special Features :**

- Simultaneous detection of CPV, CCV and Giardia
- One-step testing procedure : Quick & Accurate
- High sensitivity and specificity



## Test Procedure

[ Proper sample amount collected by a swab ]

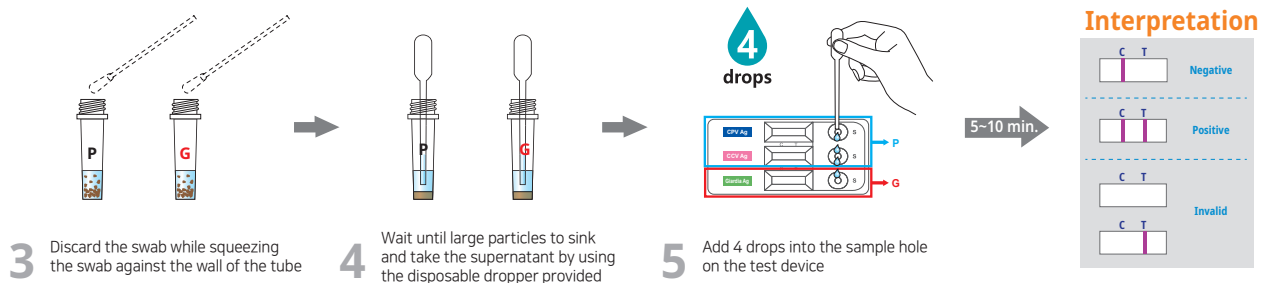
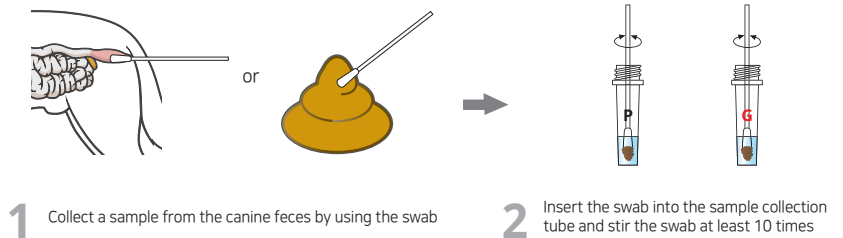
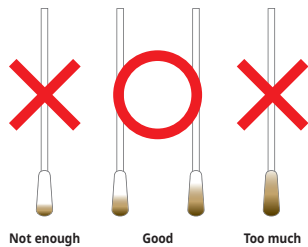

## Ordering Information

Cat. No.	Description	Type	Pack size
RC1112DC	CPV/CCV/Giardia Ag	Quattro Device	5 Tests/Kit

# CPV/CCV/Giardia Ag 2.0

## General Information

**Purpose :** Detection of Canine Parvovirus (CPV), Canine Coronavirus (CCV) and Giardia antigen

**Principle :** Immunochromatographic assay

**Specimen :** Canine fecal swab

**Materials provided :**

- Anigen Rapid CPV/CCV/Giardia Ag 2.0 test device
- Assay diluents tube for CPV/CCV Ag (P)
- Assay diluents tube for Giardia Ag (G)
- Disposable swab
- Disposable dropper

**Special Features :**

- Simultaneous detection of CPV, CCV and Giardia
- One-step testing procedure : Quick & Accurate
- High sensitivity and specificity



## Test Procedure

[ Proper sample amount collected by a swab ]

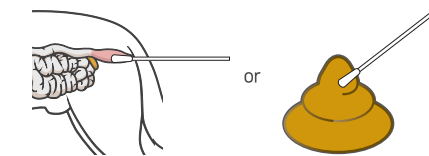
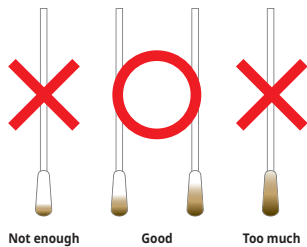

**1** Collect a sample from the canine feces by using the swab

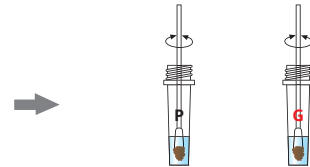

**2** Insert the swab into the sample collection tube and stir the swab at least 10 times

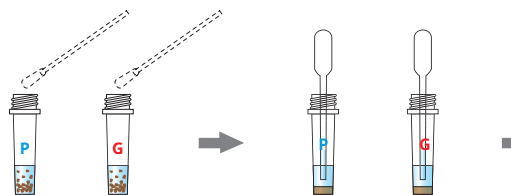

**3** Discard the swab while squeezing the swab against the wall of the tube

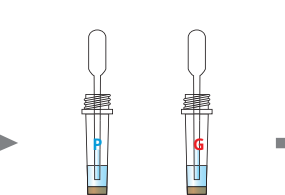

**4** Wait until large particles to sink and take the supernatant by using the disposable dropper provided

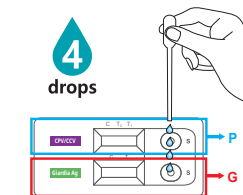

**5** Add 4 drops into the sample hole on the test device

5~10 min.

### Interpretation

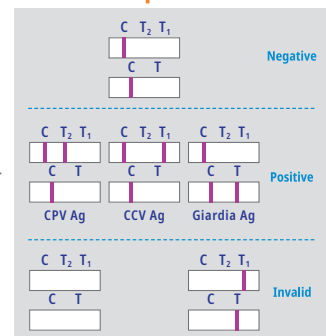

## Ordering Information

Cat. No.	Description	Type	Pack size
RC1115DC	CPV/CCV/Giardia Ag 2.0	Quattro Device	5 Tests/Kit

# CDV Ag

## General Information

**Purpose :** Detection of Canine Distempervirus (CDV) antigen

**Principle :** Immunochromatographic assay

**Specimen :** Canine conjunctival swab (Recommended), urine, serum or plasma

**Materials provided :**

- Anigen Rapid CDV Ag test device
- Assay diluents tube
- Disposable swab
- Disposable dropper

**Special Features :**

- No interference of test results by the vaccination
- One-step testing procedure : Quick & Accurate
- High sensitivity and compared with Nested PCR, PLA
  - Sensitivity : 98.8%
  - Specificity : 97.7%



## Test Procedure

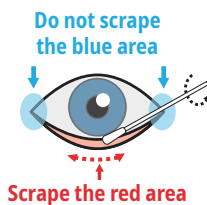

**1** Collect conjunctiva sample from the 3rd eye lid (Red colored area)



**2** Insert the swab into the sample collection tube and stir the swab at least 10 times



**3** Discard the swab while squeezing the swab against the wall of the tube



**4** Take the supernatant by using the disposable dropper provided



**4**  
drops

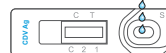

**5** Add 4 drops into the sample hole on the test device

5-10 min.

### Interpretation

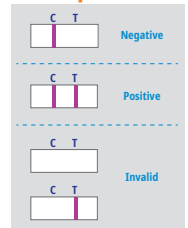

## Ordering Information

Cat.No.	Description	Type	Pack size
RG1103DD	CDV Ag	Device	10 Tests/Kit

# Anigen Rapid CIV Ag

## General Information

**Purpose :** Detection of Canine Influenzavirus (CIV) antigen

**Principle :** Immunochromatographic assay

**Specimen :** Canine nasal swab

**Materials provided :**

- Anigen Rapid CIV Ag test device
- Assay diluents tube
- Disposable swab
- Disposable dropper

**Special Features :**

- Detection of Canine influenza virus H3 strain antigen
- One-step testing procedure : Quick & Accurate
- High sensitivity and specificity compared with RT-PCR and HA test
  - Sensitivity : 94.7%
  - Specificity : 100%



## Test Procedure

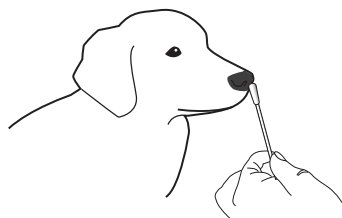

**1** Swab the nasal cavity epithelial cell



**2** Insert the swab into the sample collection tube and stir the swab at least 10 times

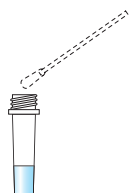

**3** Discard the swab while squeezing the swab against the wall of the tube



**4** Take the supernatant by using the disposable dropper provided



**5** Add 4 drops into the sample hole on the test device

5~10 min.

### Interpretation

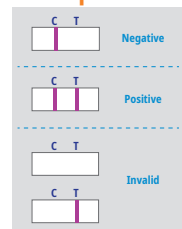

## Ordering Information

Cat. No.	Description	Type	Pack size
RG1107DD	CIV Ag	Device	10 Tests/Kit

# CDV/CAV Ag

## General Information

**Purpose :** Detection of Canine Distempervirus (CDV) and Canine Adenovirus (CAV) antigen

**Principle :** Immunochromatographic assay

**Specimen :** CDV Ag - Canine conjunctival swab, CAV Ag - Canine nasal swab

**Materials provided :**

- Anigen Rapid CDV/CAV Ag test device
- Assay diluents tube
- Disposable swab
- Disposable dropper

**Special Features :**

- Simultaneous detection of CDV and CAV with one specimen preparation
- One-step testing procedure : Quick & Accurate
- High sensitivity and specificity



## Test Procedure

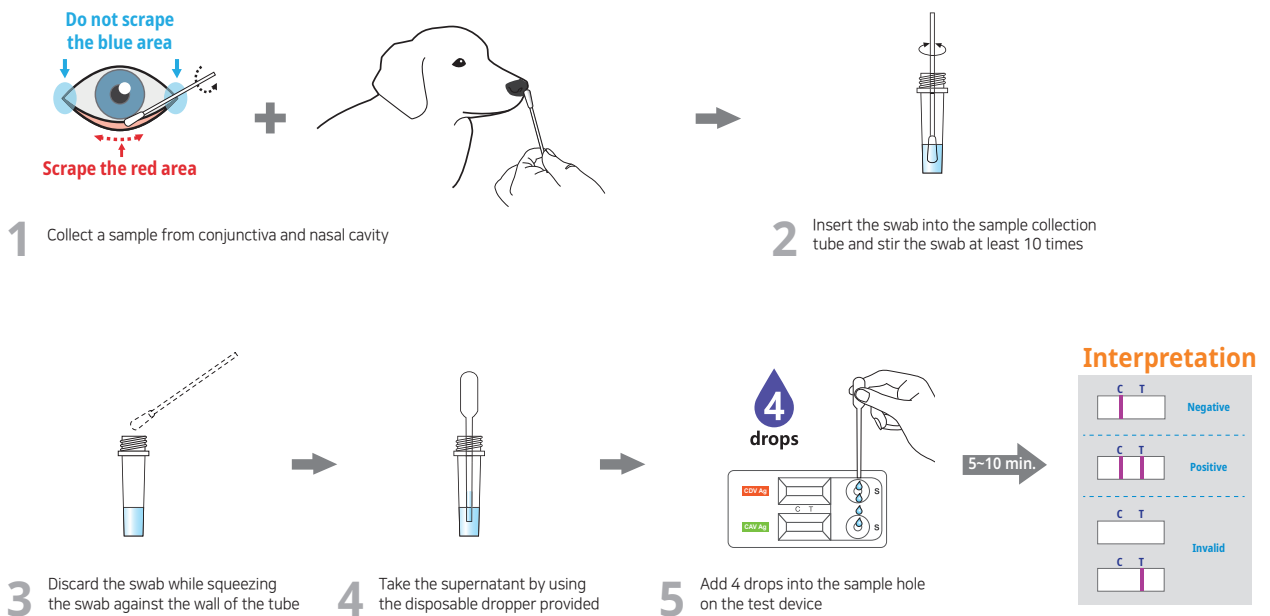

## Ordering Information

Cat. No.	Description	Type	Pack size
RC1108DD	CDV/CAV Ag	Dual Device	10 Tests/Kit



# CIRD-3 Ag

## General Information

**Purpose :** Detection of Canine Distempervirus (CDV), Canine Adenovirus (CAV), and Canine Influenzavirus (CIV) antigen

**Principle :** Immunochromatographic assay

**Specimen :** CDV Ag - Canine conjunctival swab, CAV & CIV Ag - Canine nasal swab

**Materials provided :**

- Anigen Rapid CIRD-3 Ag test device
- Assay diluents tube
- Disposable swab
- Disposable dropper

**Special Features :**

- Simultaneous detection of CDV, CAV and CIV with one specimen preparation
- One-step testing procedure : Quick & Accurate
- High sensitivity and specificity



## Test Procedure

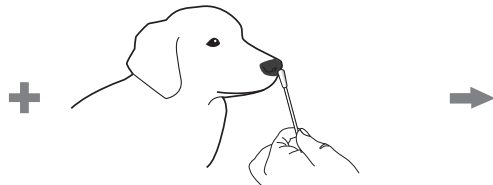
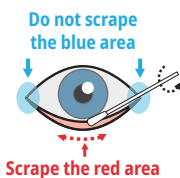

**1** Collect a sample from conjunctiva and nasal cavity

**2** Insert the swab into the sample collection tube and stir the swab at least 10 times

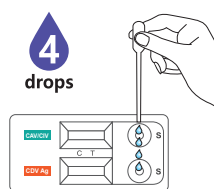
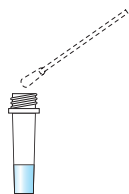

5~10 min.

**3** Discard the swab while squeezing the swab against the wall of the tube

**4** Take the supernatant by using the disposable dropper provided

**5** Add 4 drops into the sample hole on the test device

### Interpretation

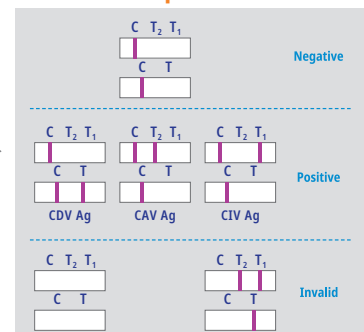

## Ordering Information

Cat. No.	Description	Type	Pack size
RC1109DD	CIRD-3 Ag	Dual Device	10 Tests/Kit

# C.Brucella Ab

## General Information

**Purpose :** Detection of canine antibody against *Brucella canis*

**Principle :** Immunochromatographic assay

**Specimen :** Canine whole blood, plasma or serum

**Materials provided :**

- Anigen Rapid C.Brucella Ab test device
- Assay diluents bottle
- Anticoagulant tube
- Disposable capillary tube

**Special Features :**

- One-step testing procedure : Quick & Accurate
- High sensitivity and specificity compared with Bacterial isolation



## Test Procedure

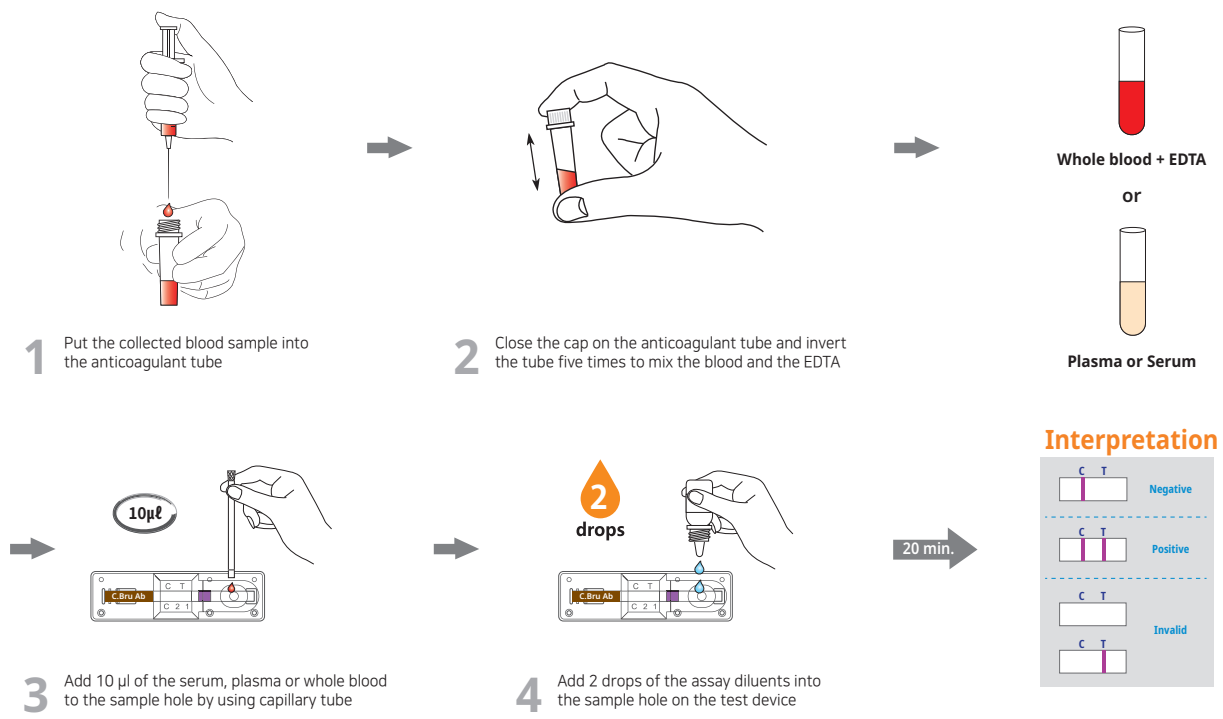

## Ordering Information

Cat. No.	Description	Type	Pack size
RB2103DD	C.Brucella Ab	Device	10 Tests/Kit

# Canine Babesia Ab

## General Information

**Purpose :** Detection of canine antibody against *Babesia gibsoni*

**Principle :** Immunochromatographic assay

**Specimen :** Canine whole blood, plasma or serum

**Materials provided :**

- Anigen Rapid Canine Babesia Ab test device
- Assay diluents bottle
- Anticoagulant tube
- Disposable capillary tube

**Special Features :**

- One-step testing procedure : Quick & Accurate
- High sensitivity and specificity compared with IFA
  - Sensitivity : 99.17%
  - Specificity : 95.14%



## Test Procedure

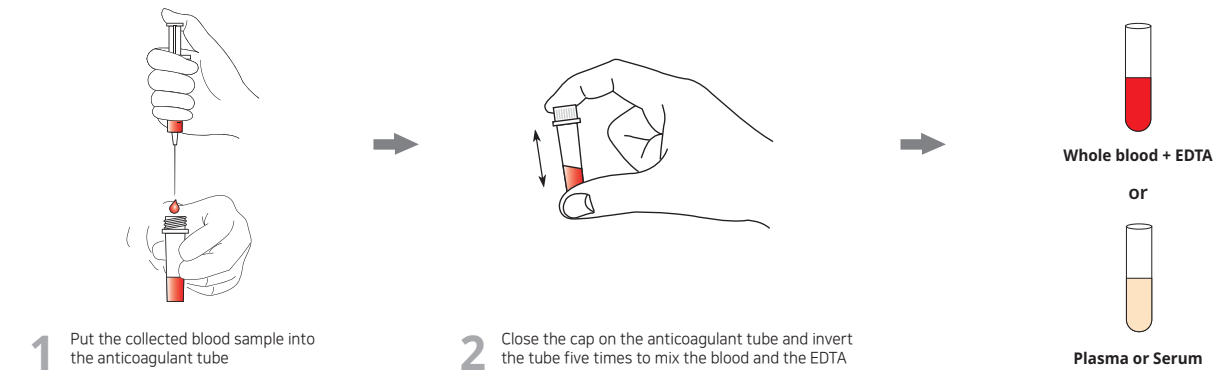

**1** Put the collected blood sample into the anticoagulant tube

**2** Close the cap on the anticoagulant tube and invert the tube five times to mix the blood and the EDTA

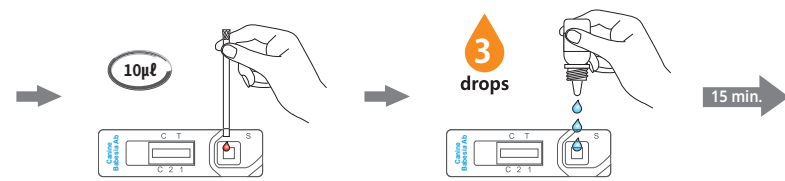

**3** Add 10 µl of the serum, plasma or whole blood to the sample hole by using capillary tube

**4** Add 3 drops of the assay diluents into the sample hole on the test device

## Interpretation

Clinical Signs	PCR	BIONOTE Canine Babesia Ab	Interpretation	Diagnosis
+	+	+	4~16 weeks after infection	Infection
+	+	-	2~4 weeks after infection	Infection
+	-	+	At least 17 weeks after infection	Recheck necessary
+	-	-	Only 1~3 weeks passed after infection	Recheck necessary

## Ordering Information

Cat. No.	Description	Type	Pack size
RB2126DD	Canine Babesia Ab	Device	10 Tests/Kit

# CHW Ag 2.0

## General Information

**Purpose :** Detection of *Dirofilaria immitis* antigen

**Principle :** Immunochromatographic assay

**Specimen :** Canine whole blood, plasma or serum

**Materials provided :**

- Anigen Rapid CHW Ag 2.0 test device
- Anticoagulant tube
- Disposable dropper

**Special Features :**

- High sensitivity even in dogs with low worm burdens (1~5 worms)
- One-step testing procedure : Quick & Accurate
- High sensitivity and specificity compared with necropsy
  - Sensitivity : 99.5%
  - Specificity : 94.0%

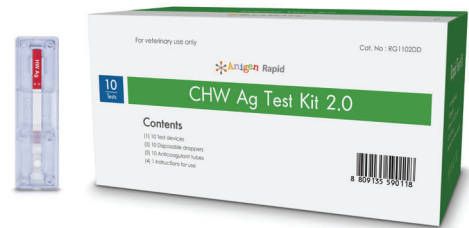

The earliest phase of heartworm antigen and microfilariae that can be detected is about 5 and 6 months post infection, respectively. Whether screening a population of asymptomatic dogs or seeking verification of a suspected heartworm infection, antigen testing is the most sensitive diagnostic method. Microfilaria testing is complementary and may be done in tandem with antigen testing to determine whether this life cycle stage is also present in dogs that are antigenemic.

## Test Procedure

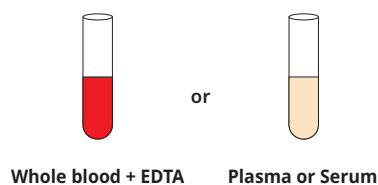

1 Prepare a sample

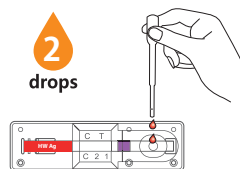

2 Add 2 drops of the blood, plasma or serum into the sample hole on the test device



### Interpretation

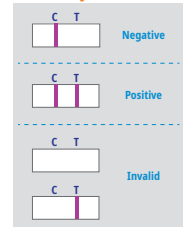

## Ordering Information

Cat. No.	Description	Type	Pack size
RG1102DD	CHW Ag 2.0	Device	10 Tests/Kit

# E.canis Ab

## General Information

**Purpose :** Detection of canine antibody against *Ehrlichia canis*

**Principle :** Immunochromatographic assay

**Specimen :** Canine whole blood, plasma or serum

**Materials provided :**

- Anigen Rapid E.canis Ab test device
- Assay diluents bottle
- Anticoagulant tube
- Disposable capillary tube

**Special Features :**

- One-step testing procedure : Quick & Accurate
- High sensitivity and specificity compared with IFA
  - Sensitivity : 98.2%
  - Specificity : 100%



## Test Procedure

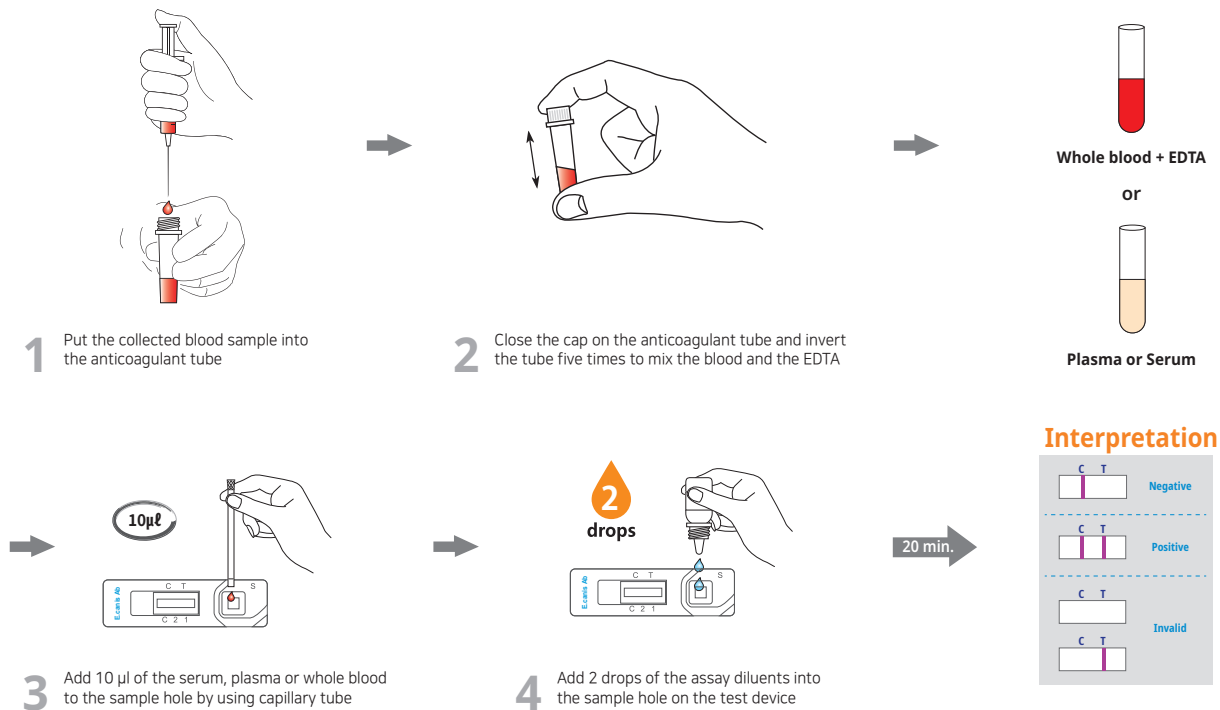

## Ordering Information

Cat. No.	Description	Type	Pack size
RB2105DD	E.canis Ab	Device	10 Tests/Kit

# Leishmania Ab

## General Information

**Purpose :** Detection of canine antibody against *Leishmania infantum*

**Principle :** Immunochromatographic assay

**Specimen :** Canine whole blood, plasma or serum

**Materials provided :**

- Anigen Rapid Leishmania Ab test device
- Assay diluents bottle
- Anticoagulant tube
- Disposable capillary tube

**Special Features :**

- One-step testing procedure : Quick & Accurate
- High sensitivity and specificity compared with IFA
  - Sensitivity : 97.2%
  - Specificity : 99.8%



## Test Procedure

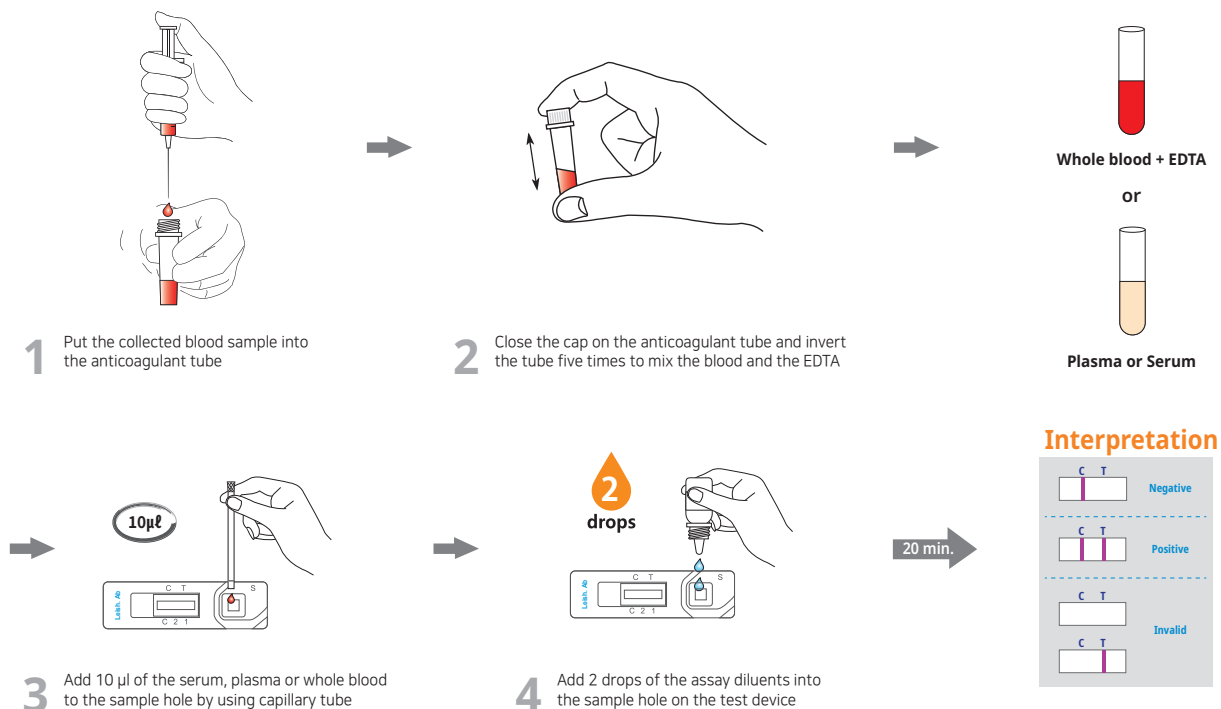

## Ordering Information

Cat. No.	Description	Type	Pack size
RB2104DD	Leishmania Ab	Device	10 Tests/Kit

# Rabies Ag

## General Information

**Purpose :** Detection of Rabies virus antigen

**Principle :** Immunochromatographic assay

**Specimen :** 10% brain homogenates

**Materials provided :**

- Anigen Rapid Rabies Ag test device
- Assay diluents tube
- Disposable swab
- Disposable dropper

**Special Features :**

- One-step testing procedure : Quick & Accurate
- High sensitivity and specificity compared with dFAT
  - Sensitivity : 96.9%
  - Specificity : 100%



## Test Procedure

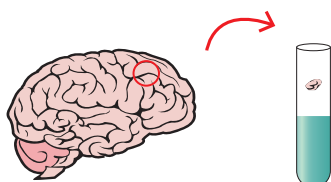

**1** Prepare 10% brain homogenates with PBS



**2** Collect a sample from brain homogenates by using the swab



**3** Insert the swab into the sample collection tube and swirl the swab at least 10 times



**4** Take the supernatant by using the disposable dropper provided



**5** Add 4 drops into the sample hole on the test device



### Interpretation

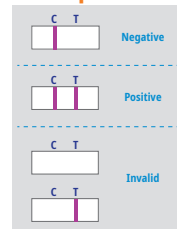

## Ordering Information

Cat. No.	Description	Type	Pack size
RG1801DD	Rabies Ag	Device	10 Tests/Kit

# Total IgE

## General Information

**Purpose :** Detection of canine total IgE antibody

**Principle :** Immunochromatographic assay

**Specimen :** Canine serum

**Materials provided :**

- Anigen Rapid Total IgE test device
- Assay diluents bottle
- Disposable capillary tube
- Disposable dropper

**Special Features :**

- Canine allergy indicator test
- One-step testing procedure : Quick & Accurate
- High sensitivity and specificity compared with ELISA
  - Sensitivity : 98.1%
  - Specificity : 94.7%



## Test Procedure



Serum

**1** Prepare a sample

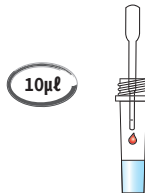

**2** Add 10 of the serum into the sample collection tube containing assay diluents

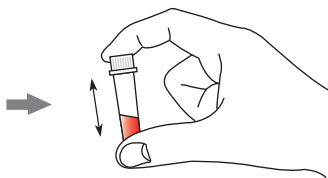

**3** Close the cap on the sample collection tube and invert the tube five times to mix

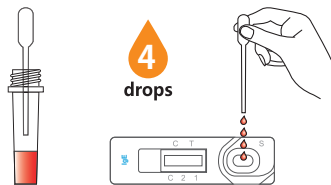

**4** Add 4 drops of the assay diluents into the sample hole on the test device



**Interpretation**

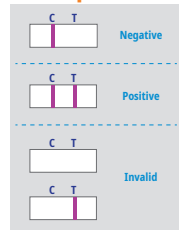

## Ordering Information

Cat. No.	Description	Type	Pack size
RB2110DD	Total IgE	Device	10 Tests/Kit



# E.canis/Anaplasma Ab

## General Information

**Purpose :** Detection of canine antibody against *E. canis* and *A. phagocytophilum/A. platys*

**Principle :** Immunochromatographic assay

**Specimen :** Canine whole blood, plasma or serum

**Materials provided :**

- Anigen Rapid E.canis/Anaplasma Ab test device
- Assay diluents bottle
- Anticoagulant tube
- Disposable capillary tube

**Special Features :**

- Simultaneous detection of E.canis Ab and Anaplasma Ab with one specimen preparation
- One-step testing procedure : Quick & Accurate
- High sensitivity and specificity compared with IFA
  - Sensitivity : Ana 96.1%
  - Specificity : Ana 99.3%



## Test Procedure

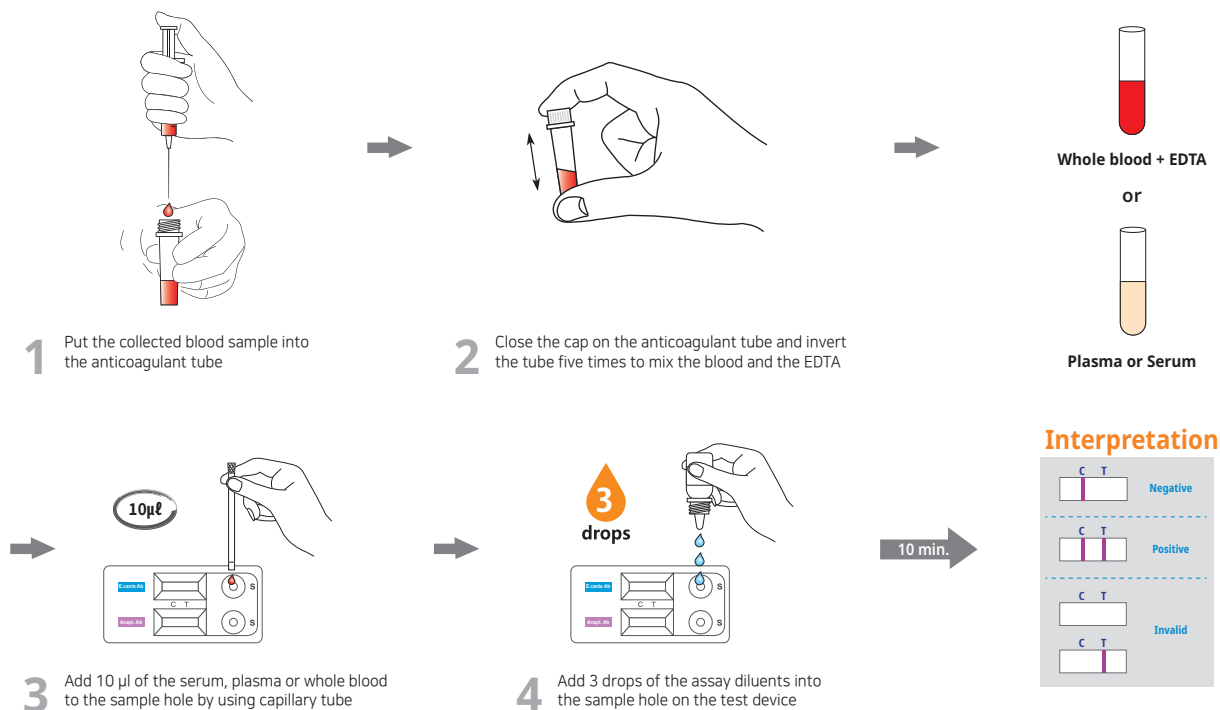

## Ordering Information

Cat. No.	Description	Type	Pack size
RC2123CD	E.canis/Anaplasma Ab	Dual Device	10 Tests/Kit

# Caniv-4

## General Information

**Purpose :** Detection of *D. immitis* antigen, canine antibody against *E. canis*, *Borrelia burgdorferi*, and *A. phagocytophilum/A. platys*

**Principle :** Immunochromatographic assay

**Specimen :** Canine whole blood, plasma or serum

**Materials provided :**

- Anigen Rapid Caniv-4 test device
- Assay diluents bottle
- Anticoagulant tube
- Disposable capillary tube

**Special Features :**

- Simultaneous detection of four kinds of Vector Borne diseases
- One-step testing procedure : Quick & Accurate
- High sensitivity and specificity

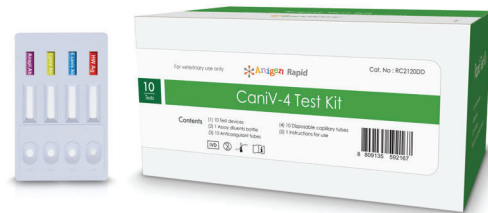

## Test Procedure

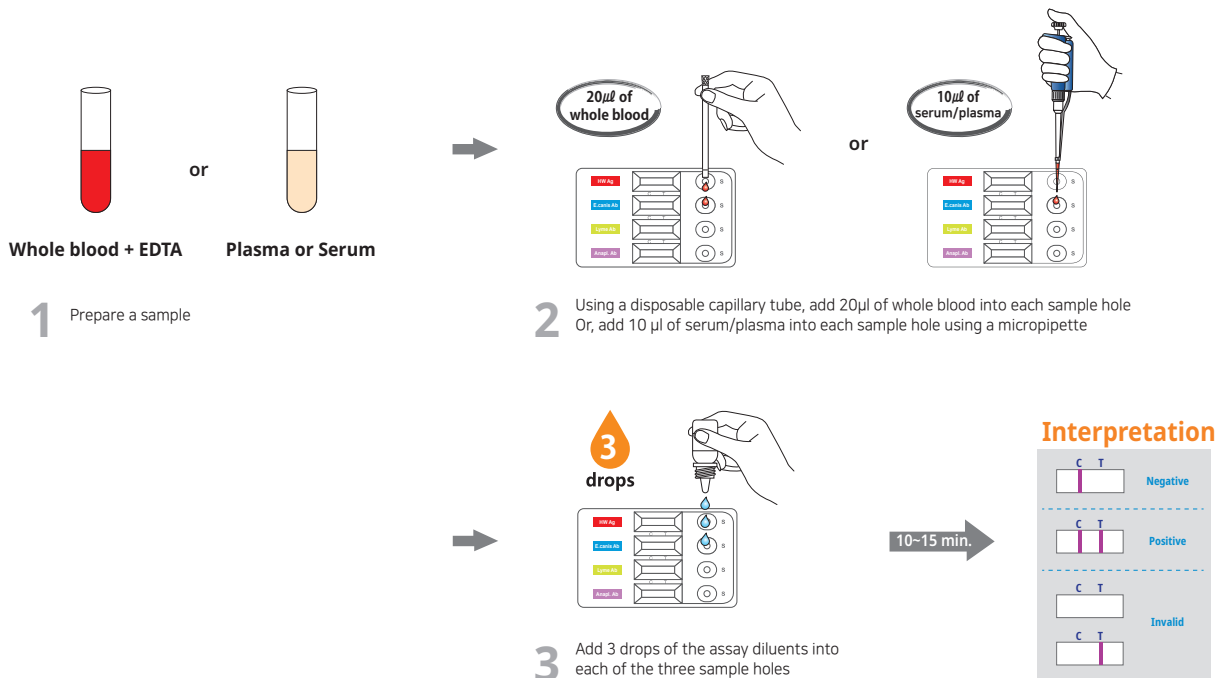

## Ordering Information

Cat. No.	Description	Type	Pack size
RC2120DD	Caniv-4	Quattro Device	10 Tests/Kit

# Caniv-4 (Leish)

## General Information

**Purpose :** Detection of *D. immitis* antigen, canine antibody against *E. canis*, *L. intantum*, and *A. phagocytophilum/A. platys*

**Principle :** Immunochromatographic assay

**Specimen :** Canine whole blood, plasma or serum

**Materials provided :**

- Anigen Rapid Caniv-4 (Leish) test device
- Assay diluents bottle
- Anticoagulant tube
- Disposable capillary tube

**Special Features :**

- Simultaneous detection of four kinds of Vector Borne diseases
- One-step testing procedure : Quick & Accurate
- High sensitivity and specificity

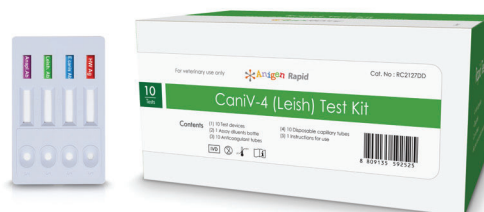

## Test Procedure

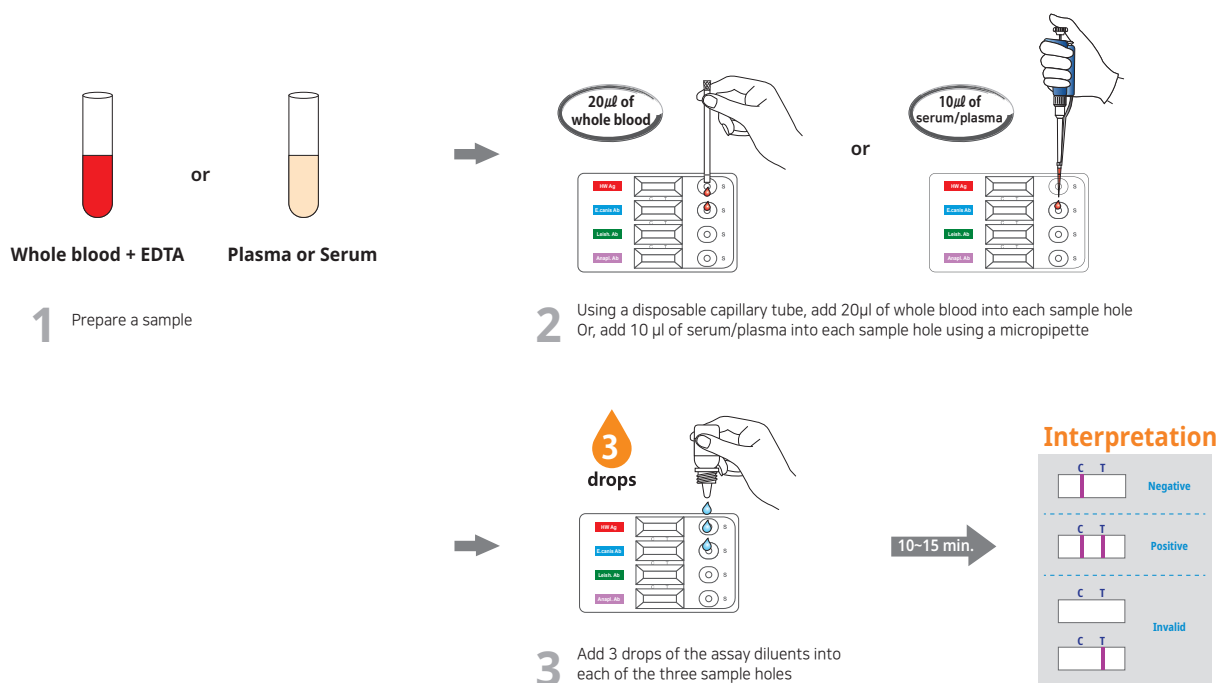

## Ordering Information

Cat. No.	Description	Type	Pack size
RC2127DD	Caniv-4 (Leish)	Quattro Device	10 Tests/Kit

# FCoV Ab

## General Information

**Purpose :** Detection of feline antibody against Feline Coronavirus (FCoV)

**Principle :** Immunochromatographic assay

**Specimen :** Feline whole blood, plasma or serum

**Materials provided :**

- Anigen Rapid FCoV Ab test device
- Assay diluents bottle
- Anticoagulant tube
- Disposable capillary tube

**Special Features :**

- One-step testing procedure : Quick & Accurate
- High sensitivity and specificity compared with IFA
  - Sensitivity : 96.0%
  - Specificity : 97.9%



- **How to do FIP diagnosis with Rapid FCoV Ab test**
  - Many healthy cats and cats with conditions other than FIP are FCoV Ab positive.
  - Some cats with effusive FIP appear to have low titers or are FCoV Ab negative.
  - FCoV Ab testing should only be performed to determine FIP in conjunction with a compatible history, clinical signs, and examination of effusions or blood for high globulins and a low A:G ratio.

## Test Procedure

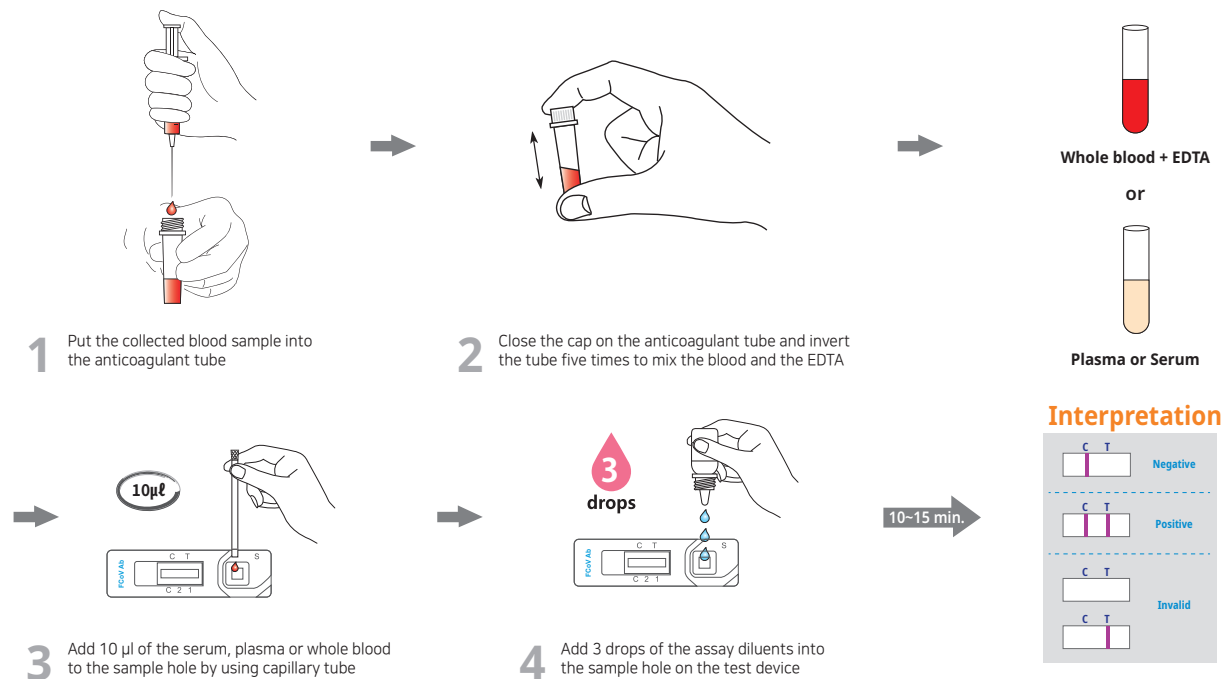

## Ordering Information

Cat. No.	Description	Type	Pack size
RB2203DD	FCoV Ab	Device	10 Tests/Kit

# Anigen Rapid

# FCoV Ag

## General Information

**Purpose :** Detection of Feline Coronavirus (FCoV) antigen

**Principle :** Immunochromatographic assay

**Specimen :** Feline fecal swab

**Materials provided :**

- Anigen Rapid FCoV Ag test device
- Assay diluents tube
- Disposable swab
- Disposable dropper

**Special Features :**

- One-step testing procedure : Quick & Accurate
- High sensitivity and specificity compared with Real-time RT-PCR
  - Sensitivity : 92.8%
  - Specificity : 98.1%



### ▪ Feline infectious peritonitis ; FIP

There are two basic forms of FIP-effusive (wet) and non effusive (dry) that have been characterized. Cats with effusive FIP usually only survive a few days-weeks at best. Cats with noneffusive FIP can survive for weeks or months, although after neurologic signs begin death usually occurs rapidly.

## Test Procedure

[ Proper sample amount collected by a swab ]

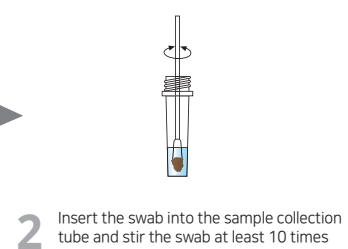
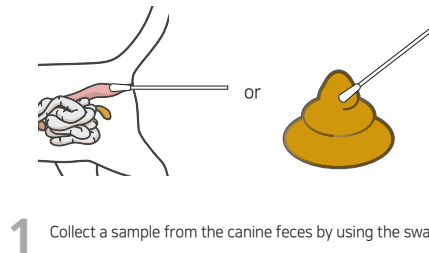
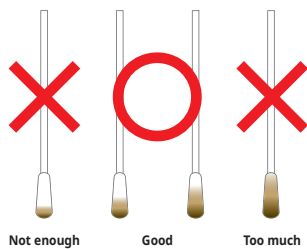

1 Collect a sample from the canine feces by using the swab

2 Insert the swab into the sample collection tube and stir the swab at least 10 times

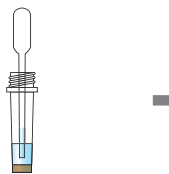
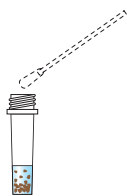

### Interpretation

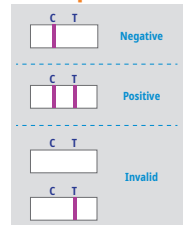

3 Discard the swab while squeezing the swab against the wall of the tube

4 Wait until large particles to sink and take the supernatant by using the disposable dropper provided

5 Add 4 drops into the sample hole on the test device

## Ordering Information

Cat. No.	Description	Type	Pack size
RG1205DD	FCoV Ag	Device	10 Tests/Kit

# Anigen Rapid FPV Ag

## General Information

**Purpose :** Detection of Feline Panleukopenia virus (FPV) antigen

**Principle :** Immunochromatographic assay

**Specimen :** Feline fecal swab

**Materials provided :**

- Anigen Rapid FPV Ag test device
- Assay diluents tube
- Disposable swab
- Disposable dropper

**Special Features :**

- One-step testing procedure : Quick & Accurate
- High sensitivity and specificity compared with conventional PCR
  - Sensitivity : 97%
  - Specificity : 98.5%

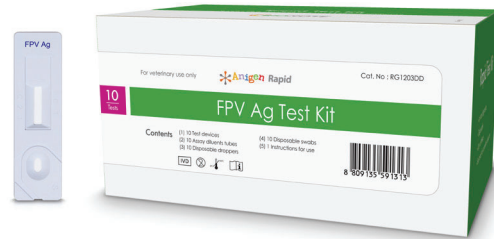

## Test Procedure

[ Proper sample amount collected by a swab ]

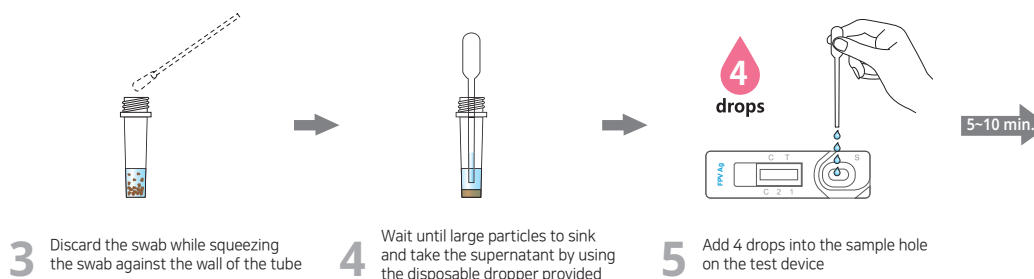
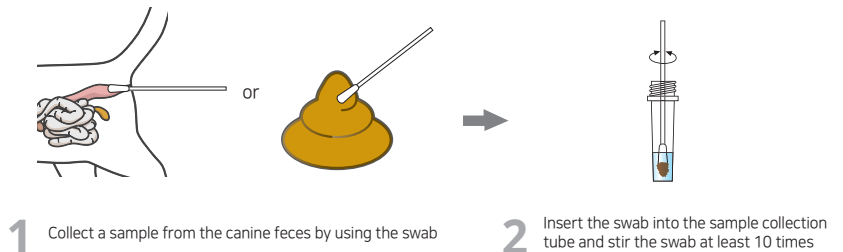
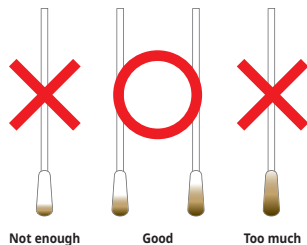

### Interpretation

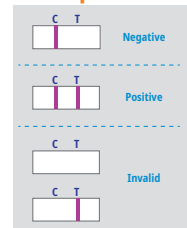

## Ordering Information

Cat. No.	Description	Type	Pack size
RG1203DD	FPV Ag	Device	10 Tests/Kit

# FCoV Ag/Ab

## General Information

**Purpose :** Detection of Feline Coronavirus (FCoV) antigen and feline antibody against FCoV

**Principle :** Immunochromatographic assay

**Specimen :** Ag - Feline fecal swab  
Ab - Feline whole blood, plasma or serum

**Materials provided :**

- Anigen Rapid FCoV Ag/Ab test device
- Sample collection tube containing assay diluents
- Disposable swab
- Disposable dropper
- Assay diluent dropping bottle
- Anticoagulant tube
- Disposable capillary tube



**Special Features :**

- One-step testing procedure : Quick & Accurate
- High sensitivity and specificity

## Test Procedure

**FCoV Ag Test**

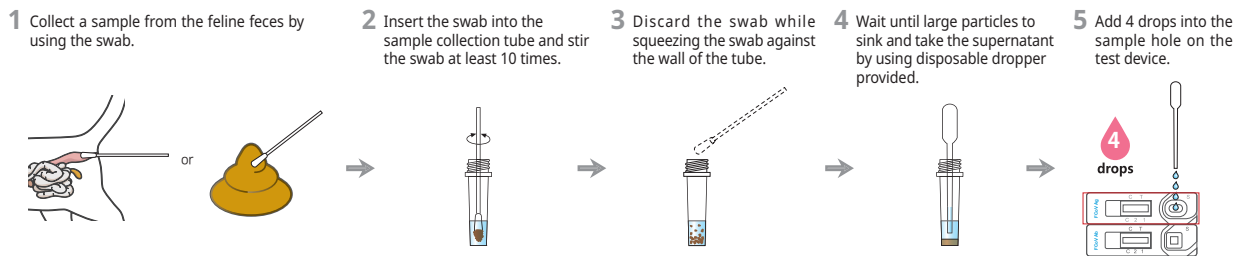

**FCoV Ab Test**

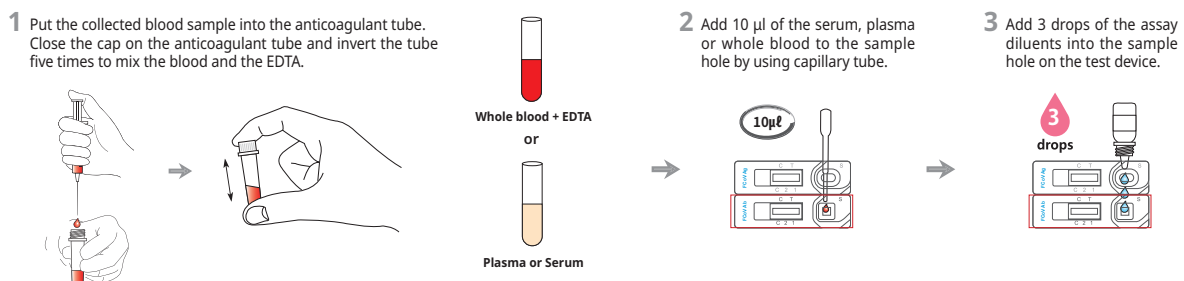

## Ordering Information

Cat. No.	Description	Type	Pack size
RC1207CC	FCoV Ag/Ab	Dual Device	5 Tests/Kit

# FeliD-3 Ag

## General Information

**Purpose :** Detection of Feline Panleukopenia virus (FPV), Feline Coronavirus (FCoV), and Giardia antigen

**Principle :** Immunochromatographic assay

**Specimen :** Feline fecal swab

**Materials provided :**

- Anigen Rapid FeliD-3 Ag test device
- Assay diluents tube for FPV/FCoV Ag (P)
- Assay diluents tube for Giardia Ag (G)
- Disposable swab
- Disposable dropper

**Special Features :**

- Able to detect pathogens in cats
- One-step testing procedure : Quick & Accurate
- High sensitivity and specificity



## Test Procedure

[ Proper sample amount collected by a swab ]

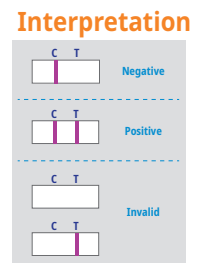
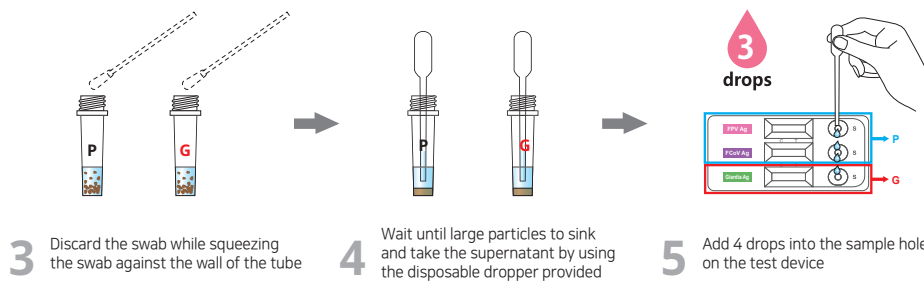
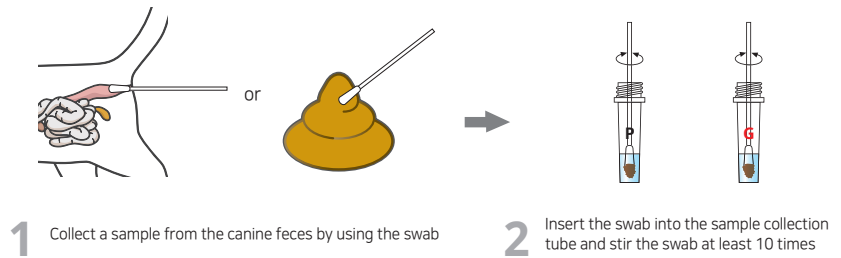
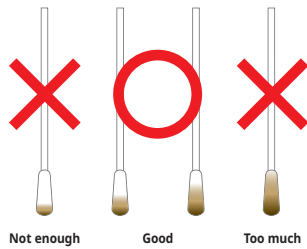

## Ordering Information

Cat. No.	Description	Type	Pack size
RC1208DC	FeliD-3 Ag	Triple Device	5 Tests/Kit



# Anigen Rapid FCV Ag

## General Information

**Purpose :** Detection of Feline Calicivirus (FCV) antigen

**Principle :** Immunochromatographic assay

**Specimen :** Feline conjunctival swab

**Materials provided :**

- Anigen Rapid FCV Ag test device
- Assay diluents tube
- Disposable swab
- Disposable dropper

**Special Features :**

- One-step testing procedure : Quick & Accurate
- High sensitivity and specificity
  - Sensitivity (LOD) :  $7.06 \times 10^5$  TCID<sub>50</sub>/ml
  - Specificity : 100% (Compared with RT-PCR)

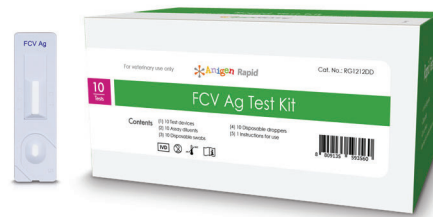

## Test Procedure

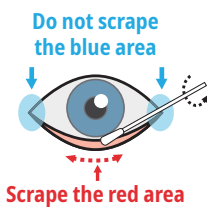

**1** Collect conjunctiva sample from the 3rd eye lid (Red colored area)

**2** Insert the swab into the sample collection tube and stir the swab at least 10 times

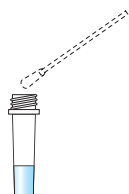

**Interpretation**

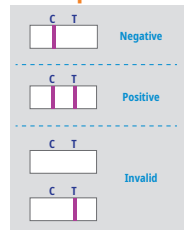

**3** Discard the swab while squeezing the swab against the wall of the tube

**4** Take the supernatant by using the disposable dropper provided

**5** Add 4 drops into the sample hole on the test device

## Ordering Information

Cat. No.	Description	Type	Pack size
RG1212DD	FCV Ag	Device	10 Tests/Kit

# Anigen Rapid FHV Ag

## General Information

**Purpose :** Detection of Feline Herpesvirus (FHV) antigen

**Principle :** Immunochromatographic assay

**Specimen :** Feline conjunctival swab

**Materials provided :**

- Anigen Rapid FHV Ag test device
- Assay diluents tube
- Disposable swab
- Disposable dropper

**Special Features :**

- One-step testing procedure : Quick & Accurate
- High sensitivity and specificity
  - Sensitivity (LOD) :  $2.92 \times 10^5$  TCID<sub>50</sub>/ml
  - Specificity : 100% (Compared with RT-PCR)

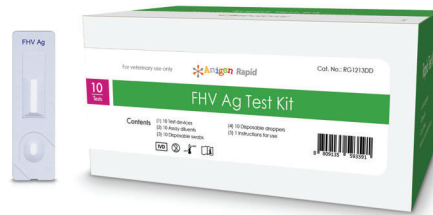

## Test Procedure

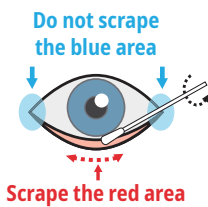

**1** Collect conjunctiva sample from the 3rd eye lid (Red colored area)

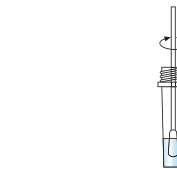

**2** Insert the swab into the sample collection tube and stir the swab at least 10 times

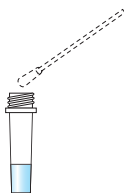

**3** Discard the swab while squeezing the swab against the wall of the tube



**4** Take the supernatant by using the disposable dropper provided



**5** Add 4 drops into the sample hole on the test device

10 min.

**Interpretation**

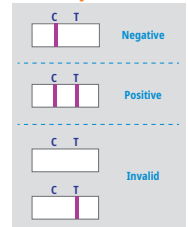

## Ordering Information

Cat. No.	Description	Type	Pack size
RG1213DD	FHV Ag	Device	10 Tests/Kit

# Toxoplasma Ab

## General Information

**Purpose :** Detection of feline antibody against *Toxoplasma gondii*

**Principle :** Immunochromatographic assay

**Specimen :** Feline whole blood, plasma or serum

**Materials provided :**

- Anigen Rapid Toxoplasma Ab test device
- Assay diluents bottle
- Anticoagulant tube
- Disposable capillary tube

**Special Features :**

- One-step testing procedure : Quick & Accurate
- High sensitivity and specificity compared with ELISA
  - Sensitivity : 100%
  - Specificity : 98.7%



## Test Procedure

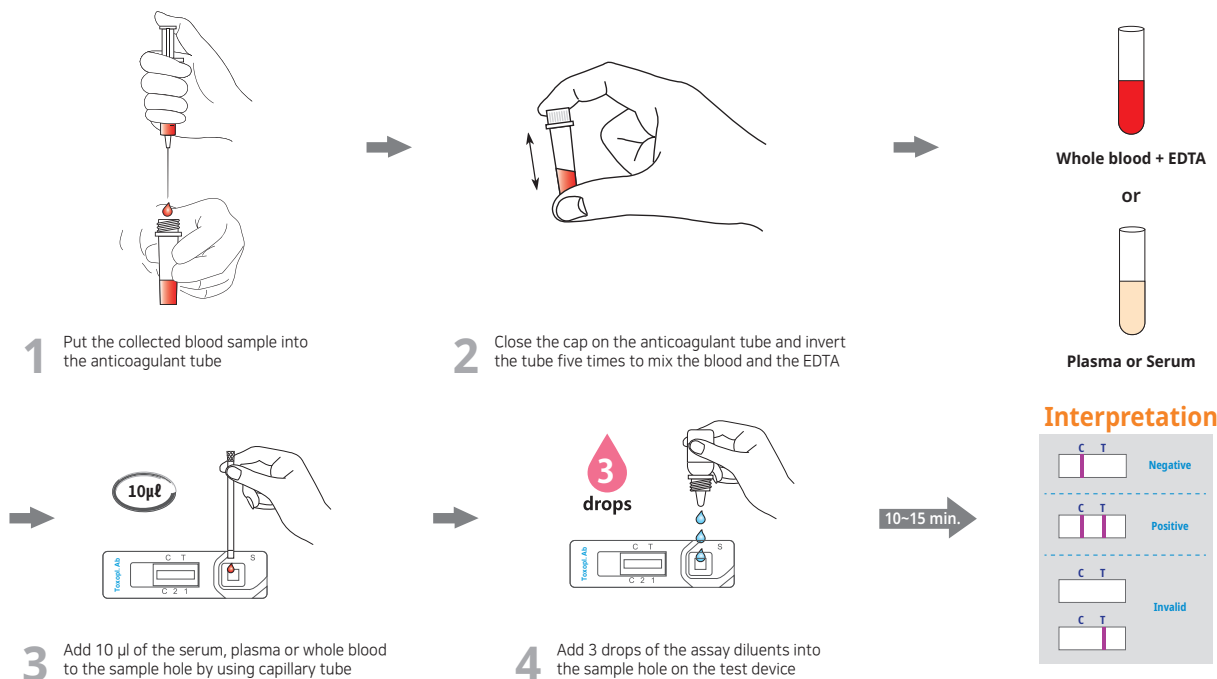

## Ordering Information

Cat. No.	Description	Type	Pack size
RB2206CC	Toxoplasma Ab	Triple Device	5 Tests/Kit

# Anigen Rapid

# FHW Ag/Ab

## General Information

**Purpose :** Detection of *Dirofilaria immitis* antigen and feline antibody against *D. immitis*

**Principle :** Immunochromatographic assay

**Specimen :** Feline whole blood, plasma or serum

**Materials provided :**

- Anigen Rapid FHW Ag/Ab test device
- Assay diluents bottle
- Anticoagulant tube
- Disposable capillary tube

**Special Features :**

- Simultaneous detection of FHW Ag and Ab with one specimen preparation
- One-step testing procedure : Quick & Accurate
- High sensitivity and specificity



Feline

## Test Procedure

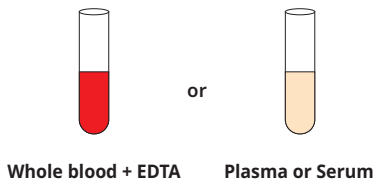

1 Prepare a sample

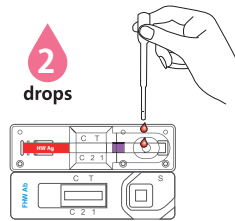

2 Use the disposable dropper and add 2 drops of the sample into the sample hole (FHW Ag)

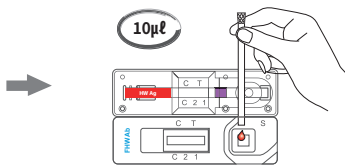

3 Add 10 µl of the serum, plasma or whole blood to the sample hole by using capillary tube

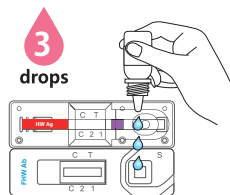

4 Add 3 drops of the assay diluents into the sample hole

10-15 min.

### Interpretation

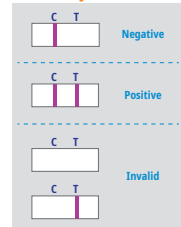

## Ordering Information

Cat. No.	Description	Type	Pack size
RC2205CD	FHW Ag/Ab	Dual Device	10 Tests/Kit

# Anigen Rapid FIV Ab

## General Information

**Purpose :** Detection of feline antibody against Feline Immunodeficiency virus (FIV)

**Principle :** Immunochromatographic assay

**Specimen :** Feline whole blood, plasma or serum

**Materials provided :**

- Anigen Rapid FIV Ab test device
- Assay diluents bottle
- Anticoagulant tube
- Disposable capillary tube

**Special Features :**

- One-step testing procedure : Quick & Accurate
- High sensitivity and specificity compared with Western blot
  - Sensitivity : 96.8 %
  - Specificity : 98.9 %

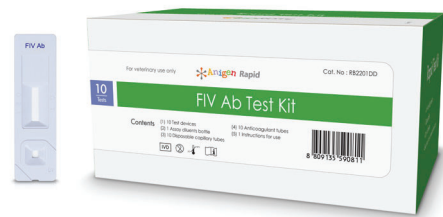

## Test Procedure

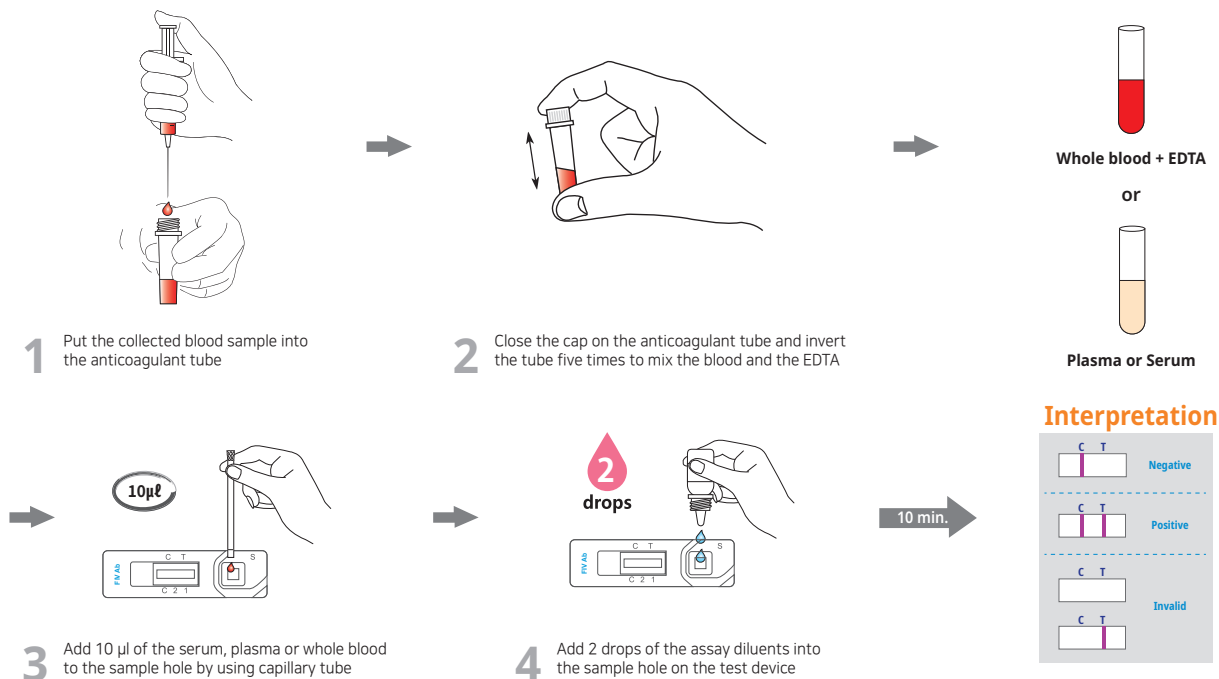

## Ordering Information

Cat. No.	Description	Type	Pack size
RB2201DD	FIV Ab	Device	10 Tests/Kit

# Anigen Rapid FeLV Ag

## General Information

**Purpose :** Detection of Feline Leukemia virus (FeLV) antigen

**Principle :** Immunochromatographic assay

**Specimen :** Feline whole blood, plasma or serum

**Materials provided :**

- Anigen Rapid FeLV Ag test device
- Assay diluents bottle
- Anticoagulant tube
- Disposable capillary tube

**Special Features :**

- One-step testing procedure : Quick & Accurate
- High sensitivity and specificity
  - Sensitivity : 100 %
  - Specificity : 100 %



## Test Procedure

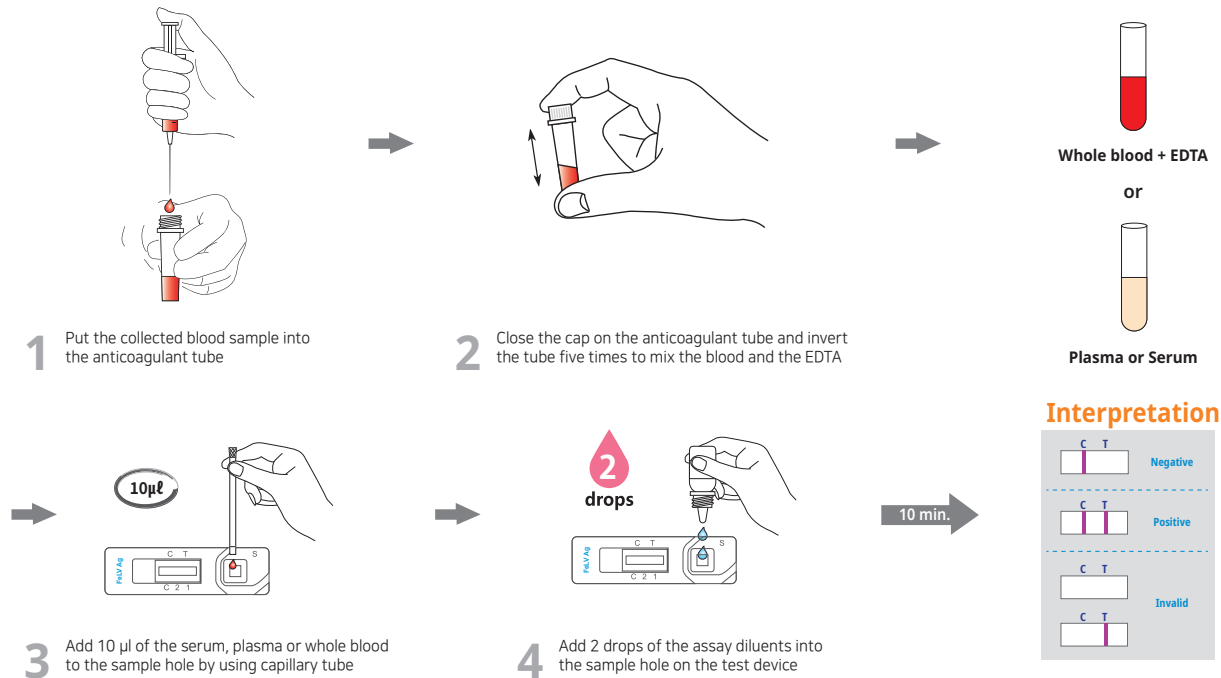

## Ordering Information

Cat. No.	Description	Type	Pack size
RG1201DD	FeLV Ag	Device	10 Tests/Kit

## Anigen Rapid

# FIV Ab/FeLV Ag

## General Information

**Purpose :** Detection of feline antibody against Feline Immunodeficiency virus (FIV) and Feline Leukemia virus (FeLV) antigen

**Principle :** Immunochromatographic assay

**Specimen :** Feline whole blood, plasma or serum

**Materials provided :**

- Anigen Rapid FIV Ab / FeLV Ag test device
- Assay diluents bottle
- Anticoagulant tube
- Disposable capillary tube



**Special Features :**

- One-step testing procedure : Quick & Accurate
- High sensitivity and specificity compared with Real-time PCR
  - Sensitivity : FIV 100% / FeLV 91%
  - Specificity : FIV 100% / FeLV 98%

▪ **FIV Ab test**

A cat in the acute phase of infection may be antibody negative, and retesting within 6-8 weeks is warranted to establish a diagnosis in cats with a recent history that puts them at risk of exposure.

▪ **FeLV Ag test**

To completely eliminate any risk to an established household when bringing in a new cat. A follow-up test should be performed at least 90 days after the initial test or possible exposure to FeLV, because cats may be in the early stage of infection at the time of the first test.

▪ **Kitten**

FIV Ab tests have to be interpreted carefully in kittens less than 6 months of age. Kittens up to 12 weeks of age can have passively acquired anti-FIV antibody from mothers that are infected or have been vaccinated. If the kittens have a FIV positive result, the kitten should be retested after 8-12 weeks. If FIV negative, the kitten is unlikely to be infected, if still positive it is probably infected.

## Test Procedure

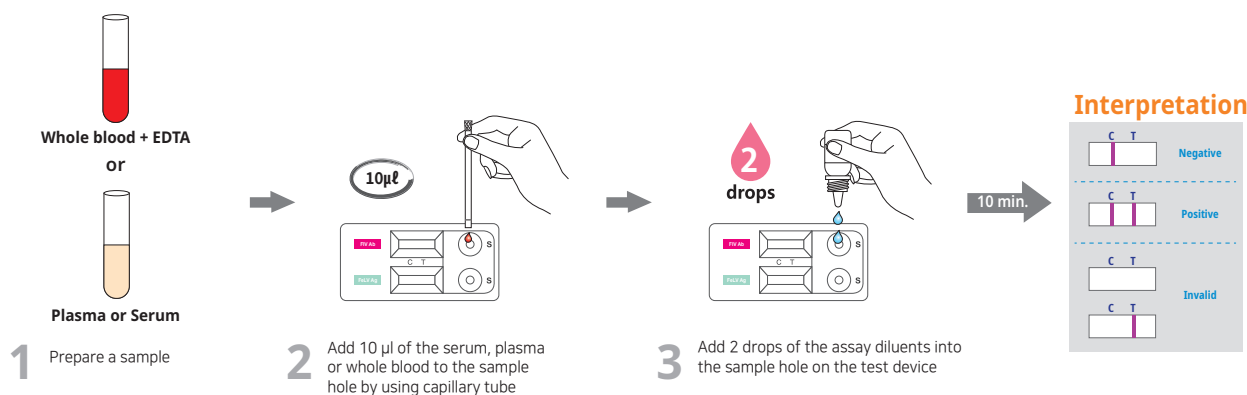

## Ordering Information

Cat. No.	Description	Type	Pack size
RC1204DD	FIV Ab/FeLV Ag	Dual Device	10 Tests/Kit

# Anigen Rapid

# FIV Ab/FeLV Ag 2.0

## General Information

**Purpose :** Detection of feline antibody against Feline Immunodeficiency virus (FIV) and Feline Leukemia virus (FeLV) antigen

**Principle :** Immunochromatographic assay

**Specimen :** Feline whole blood, plasma or serum

**Materials provided :**

- Anigen Rapid FIV Ab / FeLV Ag 2.0 test device
- Assay diluents bottle
- Anticoagulant tube
- Disposable capillary tube

**Special Features :**

- One-step testing procedure : Quick & Accurate
- High sensitivity and specificity



## Test Procedure

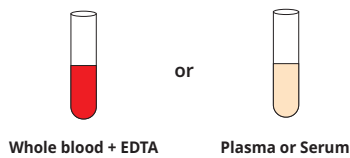

**1** Prepare a sample

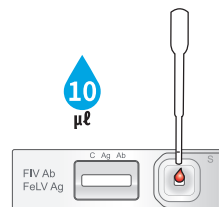

**2** Add 10 µl of the serum, plasma or whole blood to the sample hole by using capillary tube

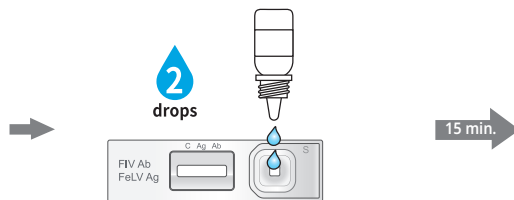

**3** Add 2 drops of the assay diluents into the sample hole on the test device

15 min.

### Interpretation

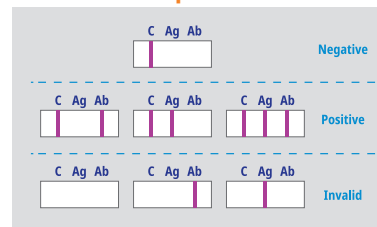

## Ordering Information

Cat. No.	Description	Type	Pack size
RC1205DD	FIV Ab/FeLV Ag 2.0	Device	10 Tests/Kit



Anigen Rapid

# FeliCheck-3

## General Information

**Purpose :** Detection of feline antibody against Feline Immunodeficiency virus (FIV), Feline Leukemia virus (FeLV) antigen, and feline antibody against *D. immitis*

**Principle :** Immunochromatographic assay

**Specimen :** Feline whole blood, plasma or serum

**Materials provided :**

- Anigen Rapid FeliCheck-3 test device
- Assay diluents bottle
- Anticoagulant tube
- Disposable capillary tube

**Special Features :**

- One-step testing procedure : Quick & Accurate
- High sensitivity and specificity



## Test Procedure

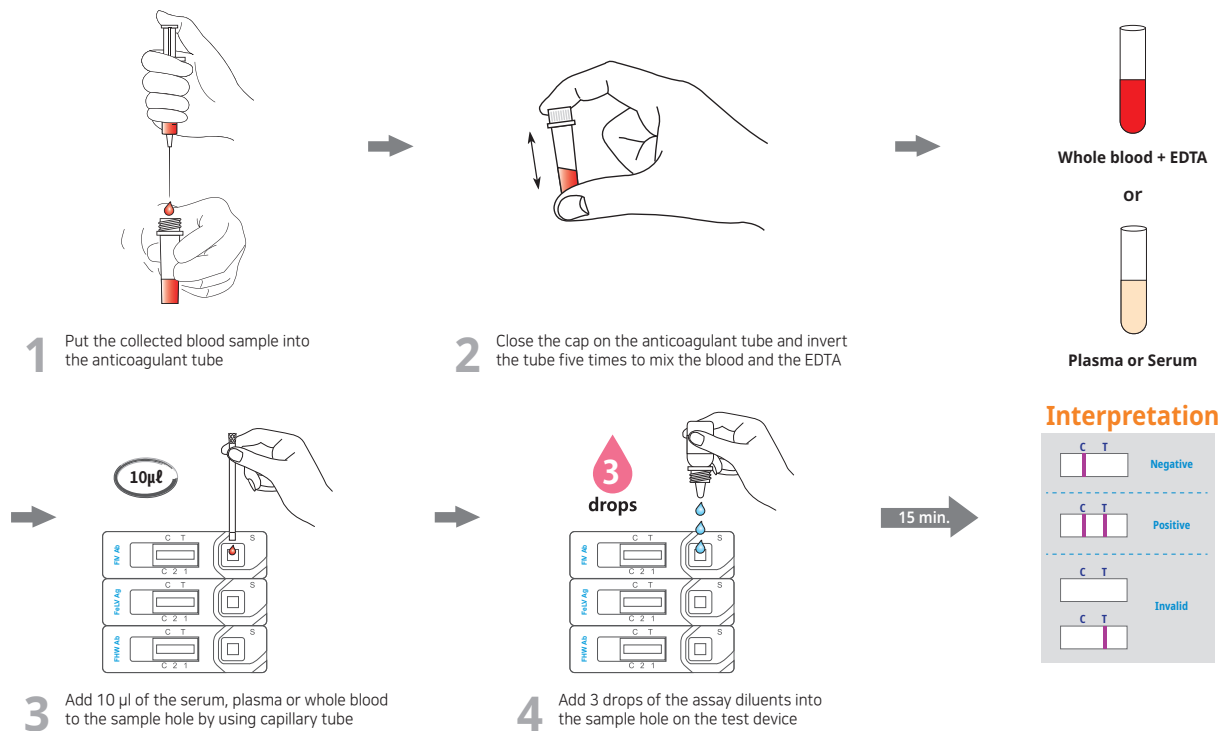

## Ordering Information

Cat. No.	Description	Type	Pack size
RC2210CC	FeliCheck-3	Triple Device	5 Tests/Kit





# Current available product list

## Rapid - CA



Species	Product	Cat. No.	Type	Packing size	Description	Sample
	Rapid CPV Ab 3.0	RB2153DD	Device	10 Tests/Kit	Titration of canine IgG antibody against canine parvovirus (CPV)	Whole blood / Plasma / Serum
	Rapid CDV Ab 3.0	RB2154DD	Device	10 Tests/Kit	Titration of canine IgG antibody against canine distemper virus (CDV)	Whole blood / Plasma / Serum
	Rapid CCV Ag	RG1104DD	Device	10 Tests/Kit	Detection of canine coronavirus antigen	Fecal swab
	Rapid CPV Ag	RG1101DD	Device	10 Tests/Kit	Detection of canine parvovirus antigen	Fecal swab
	Rapid Giardia Ag	RG1804DD	Device	10 Tests/Kit	Detection of vegetative stages and cysts of giardia	Fecal swab
	Rapid CPV/CCV Ag	RC1105DD	Dual Device	10 Tests/Kit	Detection of canine parvovirus and coronavirus antigen	Fecal swab
	Rapid CPV/CCV/Giardia Ag	RC1112DC	Triple Device	5 Tests/Kit	Detection of canine parvovirus, coronavirus and giardia antigen	Fecal swab
	Rapid CPV/CCV/Giardia Ag 2.0	RC1115DC	Triple Device	5 Tests/Kit	Detection of canine parvovirus, coronavirus and giardia antigen	Fecal swab
	Rapid CDV Ag	RG1103DD	Device	10 Tests/Kit	Detection of canine distemper virus antigen	Conjunctival swab
	Rapid CIV Ag	RG1107DD	Device	10 Tests/Kit	Detection of canine influenza virus antigen	Nasal swab
	Rapid CDV/CAV Ag	RC1108DD	Dual Device	10 Tests/Kit	Detection of canine distemper virus and adenovirus antigen	Conjunctival + nasal swab
	Rapid CIR-3 Ag	RC1109DD	Dual Device	10 Tests/Kit	Detection of canine distemper virus, adenovirus, influenza virus antigen	Conjunctival + nasal swab
	Rapid C.Brucella Ab	RB2103DD	Device	10 Tests/Kit	Detection of canine antibody against <i>Brucella canis</i>	Whole blood / Plasma / Serum
	Rapid Canine Babesia Ab	RB2126DD	Device	10 Tests/Kit	Detection of canine antibody against <i>Babesia gibsoni</i>	Whole blood / Plasma / Serum
	Rapid CHW Ag 2.0	RG1102DD	Device	10 Tests/Kit	Detection of <i>Dirofilaria immitis</i> antigen	Whole blood / Plasma / Serum
	Rapid E.canis Ab	RB2105DD	Device	10 Tests/Kit	Detection of canine antibody against <i>Ehrlichia canis</i>	Whole blood / Plasma / Serum
	Rapid Leishmania Ab	RB2104DD	Device	10 Tests/Kit	Detection of canine antibody against <i>Leishmania infantum</i>	Whole blood / Plasma / Serum
	Rapid Rabies Ag	RG1801DD	Device	10 Tests/Kit	Detection of rabies virus antigen	10% brain homogenates
	Rapid Total IgE	RB2110DD	Device	10 Tests/Kit	Detection of canine total IgE antibody	Serum
	Rapid E.canis/Anaplasma Ab	RC2123CD	Dual Device	10 Tests/Kit	Detection of canine antibody against <i>E. canis</i> and <i>A. phagocytophilum/A. platys</i>	Whole blood / Plasma / Serum
Rapid CaniV-4	RC2120DD	Triple Device	5 Tests/Kit	Detection of <i>D. immitis</i> antigen, canine antibody against <i>E. canis</i> , <i>Borrelia burgdorferi</i> , and <i>A. phagocytophilum/A. platys</i>	Whole blood / Plasma / Serum	
Rapid CaniV-4 (Leish)	RC2127DD	Triple Device	5 Tests/Kit	Detection of <i>D. immitis</i> antigen, canine antibody against <i>E. canis</i> , <i>L. infantum</i> , and <i>A. phagocytophilum/A. platys</i>	Whole blood / Plasma / Serum	
	Rapid FCoV Ab	RB2203DD	Device	10 Tests/Kit	Detection of feline antibody against feline coronavirus	Whole blood / Plasma / Serum
	Rapid FCoV Ag	RG1205DD	Device	10 Tests/Kit	Detection of feline coronavirus antigen	Fecal swab
	Rapid FPV Ag	RG1203DD	Device	10 Tests/Kit	Detection of feline panleukopenia virus antigen	Fecal swab
	Rapid FCoV Ag/Ab	RC1207CC	Dual Device	5 Tests/Kit	Detection of feline coronavirus antigen and feline antibody against FCoV	Ab - whole blood / plasma / serum Ag - fecal swab
	Rapid FeliD-3	RC1208DC	Triple Device	5 Tests/Kit	Detection of feline panleukopenia virus, coronavirus and giardia antigen	Fecal swab
	Rapid FCV Ag	RG1212DD	Device	10 Tests/Kit	Detection of feline calicivirus antigen	Conjunctival swab
	Rapid FHV Ag	RG1213DD	Device	10 Tests/Kit	Detection of feline herpesvirus antigen	Conjunctival swab
	Rapid Toxoplasma Ab	RB2206CC	Device	5 Tests/Kit	Detection of feline antibody against <i>Toxoplasma gondii</i>	Whole blood / Plasma / Serum
	Rapid FHW Ag/Ab	RC2205CD	Dual Device	10 Tests/Kit	Detection of <i>Dirofilaria immitis</i> antigen and feline antibody against <i>D. immitis</i>	Whole blood / Plasma / Serum
	Rapid FIV Ab	RB2201DD	Device	10 Tests/Kit	Detection of feline antibody against feline immunodeficiency virus	Whole blood / Plasma / Serum
	Rapid FeLV Ag	RG1201DD	Device	10 Tests/Kit	Detection of feline leukemia virus antigen	Whole blood / Plasma / Serum
	Rapid FIV ab/FeLV Ag	RC1204DD	Dual Device	10 Tests/Kit	Detection of feline antibody against feline immunodeficiency virus and leukemia virus antigen	Whole blood / Plasma / Serum
	Rapid FIV ab/FeLV Ag 2.0	RC1205DD	Device	10 Tests/Kit	Detection of feline antibody against feline immunodeficiency virus and leukemia virus antigen	Whole blood / Plasma / Serum
	Rapid Felicheck-3	RC2210CC	Triple Device	5 Tests/Kit	Detection of feline antibody against feline immunodeficiency virus, leukemia virus antigen and antibody against <i>D. immitis</i>	Whole blood / Plasma / Serum

# Current available product list

## Rapid - LS





Species	Product	Cat. No.	Type	Packing size	Description	Sample
	Rapid BovID-4 Ag Test Kit	RC1301DD	Quattro Device	1Test x 10/Kit	Detection of Bovine <i>Cryptosporidium</i> , Rotavirus, Coronavirus, <i>E. coli</i> (K99) antigen	Feces
	Rapid BovID-5 Ag Test Kit	RC1302DD	Quattro Device	1Test x 10/Kit	Detection of Bovine <i>Cryptosporidium</i> , Rotavirus, Coronavirus, <i>E. coli</i> (K99), <i>Giardia</i> antigen	Feces
	Rapid BovID-6 Ag Test Kit	RC1306DD	Quattro Device	1Test x 10/Kit	Detection of Bovine <i>Cryptosporidium</i> , Rotavirus, Coronavirus, <i>E. coli</i> (K99, F17), <i>Giardia</i> + <i>C. perfringens</i> alpha toxin	Feces
	Rapid Rota Ag Test Kit	RG1803DD	Device	1Test x 10/Kit	Detection of Rotavirus antigen	Feces
	Rapid B.Brucella Ab Test Kit	RB2301DD	Device	1Test x 10/Kit	Detection of Brucella abortus antibody in cattle	Whole blood, plasma or serum
	Rapid FMD NSP Ab Test Kit	RB2802DD	Device	1Test x 10/Kit	Detection of Foot and Mouth Disease Virus antibody field infected	Whole blood, plasma or serum
	Rapid GS.Brucella Ab Test Kit	RB2306DD	Device	1Test x 10/Kit	Detection of Brucella antibody in sheep and goat	Whole blood, plasma, serum or raw milk
	Rapid Toxoplasma Ab Test Kit (For farm animals)	RB2805DD	Device	1Test x 10/Kit	Detection of Toxoplasma <i>gondii</i> antibody	Whole blood, plasma or serum
	Rapid MERS-CoV Ag Test Kit	RG1805SG	Strip	1Test x 25/Kit	Detection of Middle East Respiratory Syndrome Coronavirus antigen	Nasal swab
	Rapid Camel Brucella Ab Test Kit	RB2309SG	Strip	1Test x 25/Kit	Detection of Brucella antibody in camel	Whole blood, plasma, serum or raw milk
	Rapid PED Ag Test Kit	RG1401DD	Device	1Test x 10/Kit	Detection of Porcine Epidemic Diarrhea virus antigen	Feces
	Rapid TGE/PED Ag Test Kit	RC1403DD	Dual Device	1Test x 10/Kit	Detection of TGE and PED virus antigen	Feces
	Rapid PED/TGE/Rota Ag Test Kit	RC1406DD	Triple Device	1Test x 10/Kit	Detection of PED, TGE and Rotavirus antigen	Feces
	Rapid Rota Ag Test Kit	RG1803DD	Device	1Test x 10/Kit	Detection of Rotavirus antigen	Feces
	Rapid FMD NSP Ab Test Kit	RB2802DD	Device	1Test x 10/Kit	Detection of Foot and Mouth Disease virus antibody field infected	Whole blood, plasma or serum
	Rapid AIV Ag Test Kit	RG1501MH	Multi Device	10Test x 3/Kit	Detection of Avian Influenza type A virus antigen	Feces or Trachea swab
	Rapid NDV Ag Test Kit	RG1503DD	Device	1Test x 10/Kit	Detection of Newcastle Disease virus antigen	Feces or Trachea swab
	Rapid IBDV Ag Test Kit	RG1504DD	Device	1Test x 10/Kit	Detection of Infectious Bursal Disease virus antigen	Bursa of Fabricious, Feces
	Rapid IBV Ag Test Kit	RG1513DD	Device	1Test x 10/Kit	Detection of Infectious Bronchitis virus antigen	Feces or Trachea swab

## ELISA



Species	Product	Cat. No.	Type	Packing size	Description	Sample
	B.Brucella Ab ELISA 2.0	EB4301PO	Microplate	480 Wells/Kit	Detection of Brucella abortus antibody	Serum, plasma, raw milk
	Brucella Ab C-ELISA	EB4305PO	Microplate	480 Wells/Kit	Detection of Brucellosis antibody C-ELISA	Serum, plasma
	BTB Ab ELISA 2.0	EB4304PO	Microplate	480 Wells/Kit	Detection of Mycobacterium bovis antibody	Serum, plasma
	FMD NSP Ab ELISA 2.0	EB4804PO	Microplate	480 Wells/Kit	Detection of Foot and Mouth Disease Virus antibody field infected	Serum, plasma
	FMD Type O Ab ELISA	EB4803PO	Microplate	480 Wells/Kit	Detection of Foot and mouth disease (FMD) SP Antibody	Serum, plasma
	TB-Feron ELISA Plus	EG3802PO	Microplate	150 Tests/Kit	Detection of Gamma-interferon in bovine tuberculosis	Plasma
	CSFV Ab ELISA	EB4413PO	Microplate	480 Wells/Kit	Detection of Classical Swine Fever Virus antibody	Serum, plasma
	PRRS Ab ELISA 4.0	EB4404PO	Microplate	480 Wells/Kit	Detection of Porcine Reproductive and Respiratory Syndrome Virus antibody	Serum, plasma
	PED IgA Ab ELISA	EB4410PO	Microplate	480 Wells/Kit	Detection of IgA for Porcine Epidemic Diarrhea Virus	Colostrum
	AIV Ab ELISA	EB4502PO	Microplate	480 Wells/Kit	Detection of AIV type A antibody	Serum

# Current available product list

## Vcheck F

Species	Product	Cat. No.	Type	Packing size	Description	Sample
	Vcheck Canine NT-proBNP	VCF132DC	Device	5 Tests/Kit	Quantitative measurement of N-terminal pro-B type natriuretic peptide (NT-proBNP)	Serum
	Vcheck Canine TnI	VCF135DC	Device	5 Tests/Kit	Quantitative measurement of Cardiac troponin I	Serum
	Vcheck CAV Ab	VCF126DD	Device	10 Tests/Kit	Titration of Canine Adenovirus antibody	Serum, Plasma
	Vcheck cCortisol	VCF105DD	Device	10 Tests/Kit	Quantitative measurement of Canine cortisol	Serum
	Vcheck cCRP 2.0	VCF109DD	Device	10 Tests/Kit	Quantitative measurement of C-reactive protein(CRP)	Serum, Plasma
	Vcheck CCV Ag	VCF110DD	Device	10 Tests/Kit	Detection of Canine Coronavirus antigen	Feces
	Vcheck CDV Ab	VCF115DD	Device	10 Tests/Kit	Titration of Canine Distemper virus antibody	Serum, Plasma
	Vcheck CDV Ag	VCF111DD	Device	10 Tests/Kit	Detection of Canine Distemper virus antigen	Conjunctiva, urine, plasma or serum
	Vcheck CHW Ag	VCF117DD	Device	10 Tests/Kit	Detection of Canine Heartworm antigen	Whole blood, plasma or serum
	Vcheck cPL	VCF103DD	Device	10 Tests/Kit	Quantitative measurement of Canine pancreas-specific lipase	Serum
	Vcheck cProgesterone	VCF122DD	Device	10 Tests/Kit	Quantitative measurement of canine Progesterone	Serum
	Vcheck CPV Ab	VCF116DD	Device	10 Tests/Kit	Titration of Canine Parvovirus antibody	Serum, Plasma
	Vcheck CPV Ag	VCF112DD	Device	10 Tests/Kit	Detection of Canine Parvovirus antigen	Feces
	Vcheck CPV/CCV Ag (3 lines)	VCF114DD	Device	10 Tests/Kit	Detection of Canine Parvovirus & Canine Coronavirus antigen	Feces
	Vcheck cTSH	VCF118DC	Device	5 Tests/Kit	Quantitative measurement of canine TSH	Serum
Vcheck D-dimer	VCF107DD	Device	10 Tests/Kit	Quantitative measurement of canine D-dimer	Plasma	
	Vcheck FCV Ab	VCF121DD	Device	10 Tests/Kit	Titration of Feline Calicivirus antibody	Serum, Plasma
	Vcheck Feline NT-proBNP	VCF130DD	Device	5 Tests/Kit	Quantitative measurement of N-terminal pro-B type natriuretic peptide (NT-proBNP)	Serum
	Vcheck Feline TnI	VCF139DD	Device	5 Tests/Kit	Quantitative measurement of Cardiac troponin I	Serum
	Vcheck FHV Ab	VCF119DD	Device	10 Tests/Kit	Titration of Feline Herpesvirus antibody	Serum, Plasma
	Vcheck fPL 2.0	VCF127DD	Device	10 Tests/Kit	Quantitative measurement of Feline pancreas-specific lipase	Whole blood, plasma or serum
	Vcheck FPV Ab	VCF120DD	Device	10 Tests/Kit	Titration of Feline Panleukopenia virus antibody	Serum, Plasma
	Vcheck FPV Ag	VCF113DD	Device	10 Tests/Kit	Detection of Feline Panleukopenia virus antigen	Feces
	Vcheck fSAA	VCF102DD	Device	10 Tests/Kit	Quantitative measurement of Serum Amyloid A (SAA)	Serum, Plasma
	Vcheck SDMA	VCF125DD	Device	10 Tests/Kit	Quantitative measurement of Symmetric dimethylarginine (SDMA)	Serum, Plasma
	Vcheck T4	VCF106DD	Device	10 Tests/Kit	Quantitative measurement of T4 (thyroxine)	Serum
	Vcheck eProgesterone	VCF142DC	Device	5 Tests/Kit	Quantitative measurement of eProgesterone	Serum, Plasma
	Vcheck Equine SAA	VCF141DD	Device	10 Tests/Kit	Quantitative measurement of Equine SAA	Serum, Plasma
	Vcheck Foal IgG	VCF143DC	Device	5 Tests/Kit	Quantitative measurement of Foal IgG	Whole blood, plasma or serum

## Vcheck M

Species	Product	Cat. No.	Type	Packing size	Description	Sample
	Vcheck M Babesia gibsoni/canis	VCM102AC	Catridge	5 Tests/Kit	Detection of canine <i>Babesia gibsoni/canis</i>	
	Vcheck M Canine Anemia 8 Panel	VCM105AC	Catridge	5 Tests/Kit	Detection of eight canine anemia diseases	
	Vcheck M Canine Vector 8 Panel	VCM104AC	Catridge	5 Tests/Kit	Detection of eight canine vector-borne diseases	
	Vcheck M Ehrlichia/Anaplasma	VCM101AC	Catridge	5 Tests/Kit	Detection of canine & feline <i>Ehrlichia and Anaplasma</i>	
	Vcheck M ASFV	VCM106AC	Catridge	5 Tests/Kit	Detection of African Swine Fever Virus	



Distributed in Australia by  
LIFE BIOSCIENCE Pty Ltd  
10 Atherton Road  
Oakleigh VIC 3166  
Tel: 03 95684140  
E: [info@lifebioscience.com.au](mailto:info@lifebioscience.com.au)



Manufactured by

**BIONOTE, Inc.**

22, Samsung 1-ro 4-gil, Hwaseong-si, Gyeonggi-do, 18449, Republic of Korea  
TEL: 82-31-211-0516 | FAX: 82-31-8003-0618 | [www.bionote.co.kr](http://www.bionote.co.kr)