

# FMD NSP Ab

## Food and mouth disease virus antibody

Foot-and-mouth disease (FMD) is a highly contagious viral infection primarily of cloven-hoofed domestic animals, such as cattle, pigs, sheep, goats, deer, and water buffalo. In many countries the disease is controlled by vaccinations that consist of (partly) purified structural proteins (SP) of the FMD virus, and therefore vaccinated animals only elicit antibodies directed against the structural proteins. Non structural protein (NSP) is expressed only by replicating viruses, and inactivated vaccines are purified to remove the cellular proteins and NSP. Therefore, only animals that have been infected with wild type develop antibodies against NSP. It is important to differentiate SP and NSP antibodies in countries that use vaccination to control FMDV outbreaks to discriminate wild type infections and immune response to vaccination.



## Indications

- To discriminate between infection and vaccination
- For field diagnosis of FMD in non-vaccination herds
- Tentative diagnosis for swift control in outbreak suspected situation

## Special Features

- No cross reaction with vaccinated group
- Specimens: Blood, Plasma, Serum
- Applicable to all artiodactyl mammal (Cattle, Sheep, Goat, Pig)
- Sensitivity: 95.4% vs. Commercial ELISA
- Specificity: 100% vs. Commercial ELISA

## Test Procedures

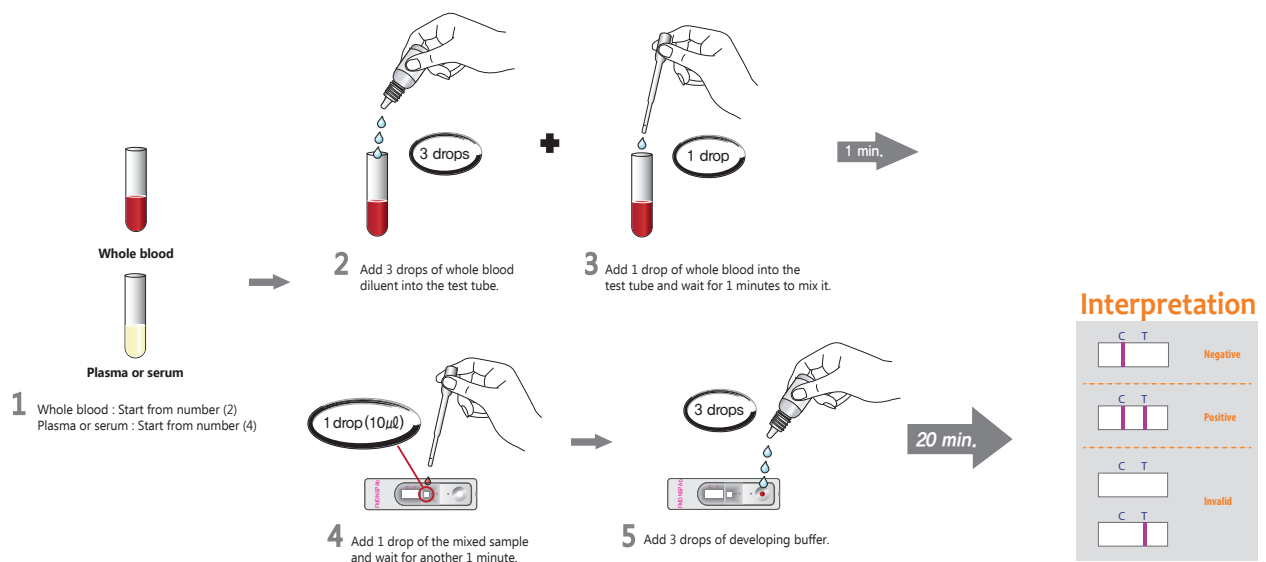

## Ordering Information

Cat. No.	Description	Type	Pack size
RB28-02	Rapid FMD NSP Ab	Device	1 Test x 10/Kit